

# FAN TYPE RV12



## 1. Construction and application of the fan.

Housing of the fan is made of steel sheet covered by pulverized lacquer. Motor with external rotor located inside of the housing is screwed by screw M4. Metallic rotor of the fan is assembled directly on external rotor of the motor. Sucking flange of the fan is secured by the shield that make touching of the moving parts (blower) impossible. The fan could has flap on inlet – that serves to regulation of efficiency – or flat on outlet – that serves to reduction of natural draught. Motor of the fan is adapted for tension regulation of speed of rotation. The fan has CE declaration of conformity.

The fans RV-12 made in different variations are assign for blowing of the air in the central heating boilers and other technological devices in the ambient temperature from  $-15^{\circ}\text{C}$  to  $+40^{\circ}\text{C}$  and relative humidity to 95%. The fan is not is not assign to work as individual device for home usage or similar.

Primary application – coal boilers ,boilers with feeding device 25-50 kW.

## 2. Drawing

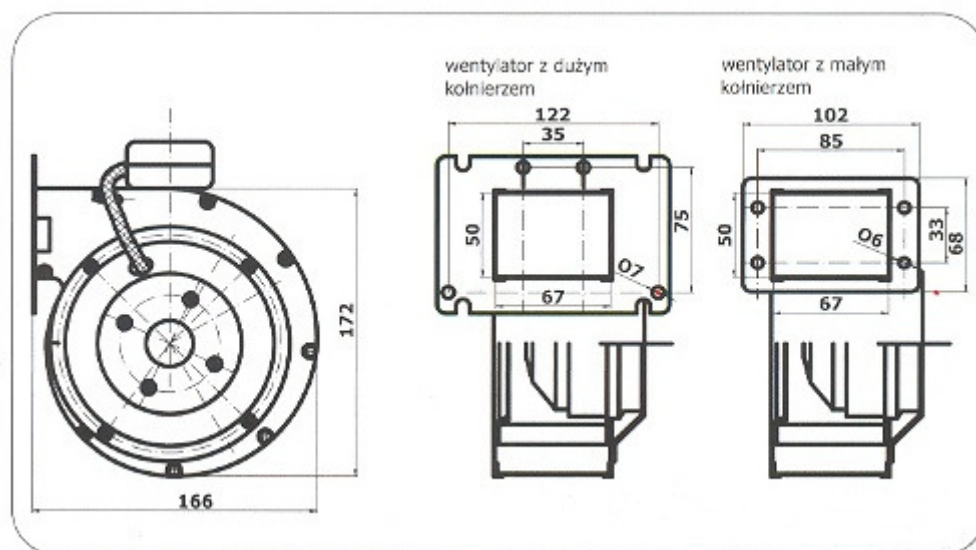

### 3. Technical data

Type of driving motor	Inductive with work capacity, external rotor
Voltage rating	230 V
Rated frequency	50 Hz
Power input	70 W
Rated current	0,35 A
Maximum efficiency	240 m <sup>3</sup> /h
Maximum swell	310 Pa
Rotation with maximum efficiency	2450 r/m
Rotation with maximum swell	2850 r/m
Type of work	S1
Position of work	Any
Grade of protection	IP 20
Primary isolation	B Class
Protection of abnormal using	Thermal protector of the motor
Level of acoustic power	<60 db(A)
Weight	2,0 kg
Minimum feed's voltage	80 V

### 4. Characteristic of the fan

