

Installation Instructions

for use by heating contractor

VISSMANN®

Cascade Communication Module, KMK Bus

Part No. 7441 586

For Vitodens 200-W model WB2B/B2HA

Safety and Installation Requirements

Please ensure that these instructions are read and understood before starting any service work. Failure to comply with these instructions may cause product/property damage, severe personal injury and/or loss of life.

Working on the equipment

The installation, adjustment, service and maintenance of this product must be performed by a licensed professional heating contractor who is qualified and experienced in the installation, service, and maintenance of hot water boilers.

There are no user serviceable parts on the boiler, burner or control.

Ensure that main power to the equipment being serviced is off.

Ensure that the main fuel supply valve to the boiler is closed.

Take precautions to avoid accidental activation of power or fuel during service work.

Do not perform service work on any component part without ensuring safe operation of the heating system. When replacing parts, use original Viessmann or Viessmann approved replacement parts.



Refer to the Installation and Start-up/Service Instructions applicable to this boiler.

Application

Cascade communication module for use with WB2B/B2HA series boilers in conjunction with Vitocontrol-S WB2B/Vitotronic 300K type, MW2B cascade control and Vitotronic HC1 and HO1B boiler control interface.

Digital outdoor reset boiler and heating system control. Master control for up to 4 boilers (WB2B), 8 boilers (B2HA), controlling two heating circuits with mixing valve and domestic hot water production.

Installing Module on WB2B/B2HA Series Boiler Control Board

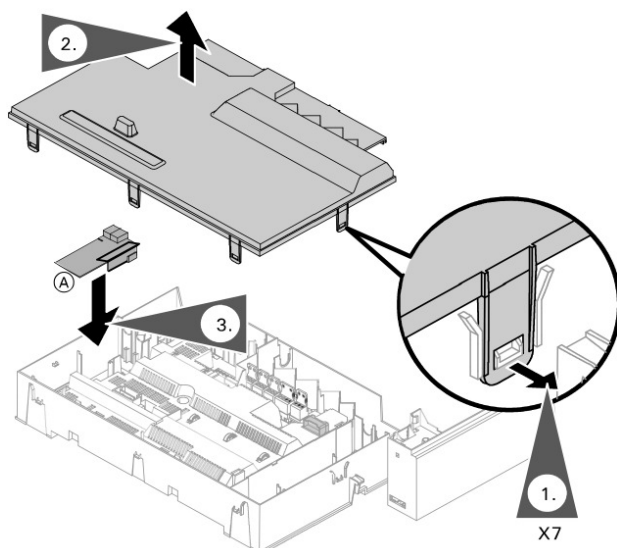

IMPORTANT

Electronic modules are static sensitive can be damaged by electrostatic discharges. Before handling electronic modules discharge static loads by touching grounded objects, such as heating or water pipes.

Legend

Ⓐ Cascade communication module

Connecting the Module

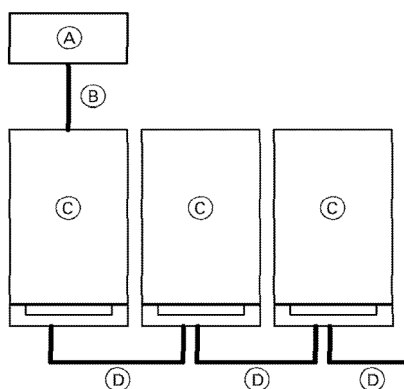

Note: The total length of BUS cables (B) and (D) should not exceed 164 ft. (50 m).

Legend

- (A) Vitocontrol-S, WB2B/Vitotronic 300K type, MW2B
- (B) KMK-BUS
- (C) Vitotronic 100, HC1 or Vitotronic 200, HO1B (boiler control interface)
- (D) 2-core Cable
[cable cross-section 2 x 0.5 mm²,
total length 164 ft. (50 m)]

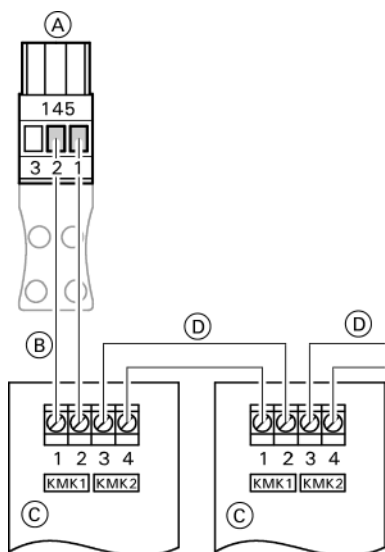

Legend

- (A) Plug 145 to the Vitocontrol-S or Vitotronic 300K type, MW2B
- (B) KMK-BUS
- (C) Terminal strip "KMK1/KMK2" at the cascade communication module of the Vitotronic 100/200
- (D) 2-core Cable
[cable cross-section 2 x 0.5 mm²,
total length 164 ft. (50 m)]

Cascade communication modules

Enclosure Removal



For more details on enclosure removal refer to the Installation and Start-up/Service Instructions applicable to this boiler.

