

BALL VALVES

0623EN September 2017

VALVE FOR WATER FOR HEATING/COOLING SYSTEMS
AND NOT DANGEROUS GAS
FULL PORT - R914L SERIES



R914L

Description

DADO ball valve, with female-male threaded connections.
Full port.

Versions and product codes

Product code	Connections	Finishing	Handle type	Handle color	Notes
R914LX021	1/4"F (ISO 228) x 1/4"M (R, EN 10226)	Nickel plated brass	Lever	Red	DADO ball
R914LX022	3/8"F (ISO 228) x 3/8"M (R, EN 10226)	Nickel plated brass	Lever	Red	DADO ball
R914LX023	1/2"F (ISO 228) x 1/2"M (R, EN 10226)	Nickel plated brass	Lever	Red	DADO ball
R914LX024	3/4"F (ISO 228) x 3/4"M (R, EN 10226)	Nickel plated brass	Lever	Red	DADO ball
R914LX025	1"F (ISO 228) x 1"M (R, EN 10226)	Nickel plated brass	Lever	Red	DADO ball
R914LX026	1 1/4"F (ISO 228) x 1 1/4"M (R, EN 10226)	Nickel plated brass	Lever	Red	DADO ball
R914LX027	1 1/2"F (ISO 228) x 1 1/2"M (ISO 228)	Nickel plated brass	Lever	Red	DADO ball
R914LX028	2"F (ISO 228) x 2"M (ISO 228)	Nickel plated brass	Lever	Red	DADO ball

Technical data

Main features and materials

- Suitable for water for heating/cooling systems and not dangerous gas
- Full port
- Valve made of UNI EN 12165 CW617N nickel plated brass
- Stem with double O-Ring
- Nut with anti-corrosion coating, with guarantee seal and hologram
- Steel lever handle with anti-corrosion treatment and red PVC coating
- DADO ball

Field of applications

- Min. working temperature: -20 °C with 50 % glycol solutions
- Max. working temperature with dry saturated steam: 185 °C with 1,05 MPa (10,5 bar)
- Max. working pressure at 20 °C with water and not dangerous gas: 4,2 MPa (42 bar) for 1/4" - 3/8" - 1/2" - 3/4"; 3,5 MPa (35 bar) for 1" - 1 1/4" - 1 1/2" - 2"

Dimensions and Kv

Product code	DN	A [mm]	I [mm]	B [mm]	J [mm]	C [mm]	H [mm]	Kv
R914LX021	8	51	21	36	10	42	17	6,9
R914LX022	10	59	25	46	13	77	21	7,0
R914LX023	15	68	28	52	16	77	25	13,3
R914LX024	20	76	31	69	21	95	32	25,8
R914LX025	25	88	39	77	25	95	39	50,9
R914LX026	32	102	43	87	30	95	47	103
R914LX027	40	105	48	108	37	137	54	147
R914LX028	50	124	55	124	46	137	67	222

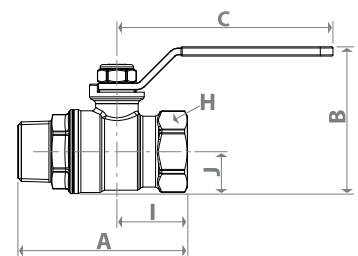

Product specifications

R914L - Red lever

DADO ball valve, with female-male threaded connections. Suitable for water for heating/cooling systems and not dangerous gas. Valve made of UNI EN 12165 CW617N nickel plated brass. Full port. Steel lever handle with anti-corrosion treatment and red PVC coating. Stem with double O-Ring. Nut with anti-corrosion coating, with guarantee seal and hologram. Min. working temperature: -20 °C with 50 % glycol solutions. Max. working temperature with dry saturated steam: 185 °C with 1,05 MPa (10,5 bar). Max. working pressure at 20 °C with water and not dangerous gas: 4,2 MPa (42 bar) for 1/4" - 3/8" - 1/2" - 3/4"; 3,5 MPa (35 bar) for 1" - 1 1/4" - 1 1/2" - 2".