

CERALINE

Exposed bath & shower mixer

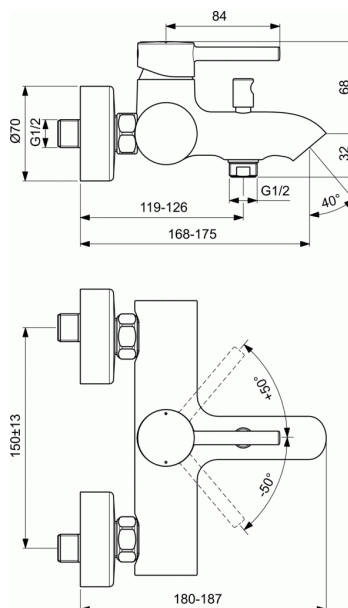

Exposed bath & shower mixer

38 mm ceramic cartridge with hot water limiter
Metal handle with red and blue colour indication
Check valve
Standard S-Connections with Noise reducers
Cache aerator
Automatic diverter
Comply with EN817

FINISHES*



AA



XG

* AA = Chrome, XG = Silk Black (Matt Black)

KEY FEATURES & BENEFITS

