

Data sheet

valid from: 2/17/18

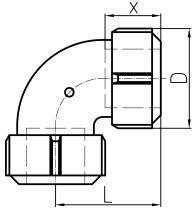

Elbow, galvanised for ISO 65 Steel pipe



Dim. (inch)	NBR Code	EPDM Code	FKM Code	SP	GP	Weight (kg)	D (mm)	L (mm)	x (mm)
3/8	775 402 050	775 406 050		1	15	0.375	45	58	30 - 34
1/2	775 402 051	775 406 051	775 408 051	1	15	0.397	45	58	30 - 34
3/4	775 402 052	775 406 052	775 408 052	1	10	0.494	51	60	30 - 34
1	775 402 053	775 406 053	775 408 053	1	10	0.674	59	60	30 - 34
1 1/4	775 402 054	775 406 054	775 408 054	1	5	0.820	68	60	30 - 36
1 1/2	775 402 055	775 406 055	775 408 055	1	5	1.000	75	76	32 - 38
2	775 402 056	775 406 056	775 408 056	1	5	1.860	96	88	36 - 42

The technical data are not binding. They neither constitute expressly warranted characteristics nor guaranteed properties nor a guaranteed durability. They are subject to modification. Our General Terms of Sale apply.

Georg Fischer Piping Systems Ltd, Postfach, CH-8201 Schaffhausen/Switzerland

Phone +41 -(0)52-631 1111

e-mail: info.ps@georgfischer.com

Internet: <http://www.gfps.com>