

Zerocal+ Maxi NEW

Anti scale proportional dosing units with liquid refill and 680 ml tank for a long lifetime

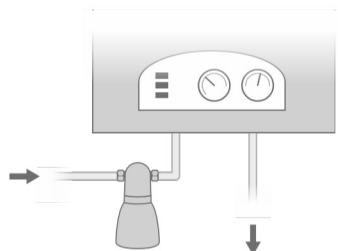

Maxi Zerocal Line

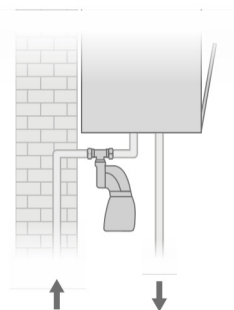

Maxi Zerocal Dima



Line

Dima

DOSING

Zerocal+ are anti scale proportional dosing units for boilers, water heaters, washing machines and dishwashers. Zerocal+ units use the technology with an immersion pump which does not damage even though there has been no anti scale liquid for long.

The ergonomic shape and the adjustable connections make installation fast and easy.

Thanks to the special Dima fittings the dosing unit can be easily installed in the small spaces between the wall and the boiler.

Zerocal+ do not require power supply.

The Sensor version is fitted with a sound and visual signal system warning you when it is time to refill the anti scale liquid (yellow led) and when it is time to replace batteries (red led).

Each pack includes a Zerocal+ DOSE 500 ml refill.

To refill the anti scale product it is not necessary to close water supply; it is enough to loosen the tank, pour in Zerocal+ DOSE and place the tank back in.

Material for pump and tank: POM/PE.

ITEM	ITEM CODE	PACK..	CONN.	MAX PRESS.	FLOW RATE MIN-MAX ($\Delta P = 0,5 \text{ bar}$)	TANK	INTERAXIS	DIMENSIONS (LxHxZ)	ALARM
		pcs.		bar	m ³ /h	ml	cm	cm	
ZEROCAL+ MAXI LINEA SENSOR 1/2"	105.075.00	3	1/2-1/2" M	1,5÷6	0,18-0,75	680	7,6	11x21x13,3	YES
ZEROCAL+ MAXI DIMA SENSOR 1/2"	105.076.00	3	1/2-1/2" F	1,5÷6	0,18-0,75	680	5,7	11x26x13,3	YES
ZEROCAL+ MAXI LINEA BASIC 1/2"	105.075.10	3	1/2-1/2" M	1,5÷6	0,18-0,75	680	7,6	11x21x13,3	NO
ZEROCAL+ MAXI DIMA BASIC 1/2"	105.076.10	3	1/2-1/2" F	1,5÷6	0,18-0,75	680	5,7	11x26x13,3	NO

Water temperature: 5-40 °C; Ambient temperature: 5-50 °C – Battery: 3V Lithium CR 2032