

ACCESSORIES FOR WATER SOFTENERS

CONTENTS

1. INSTALLATION	3
2. EXPLODED VIEW	5
3. BEFORE STARTING CHECK THAT ...	6
4. TROUBLESHOOTING	6

1. INSTALLATION

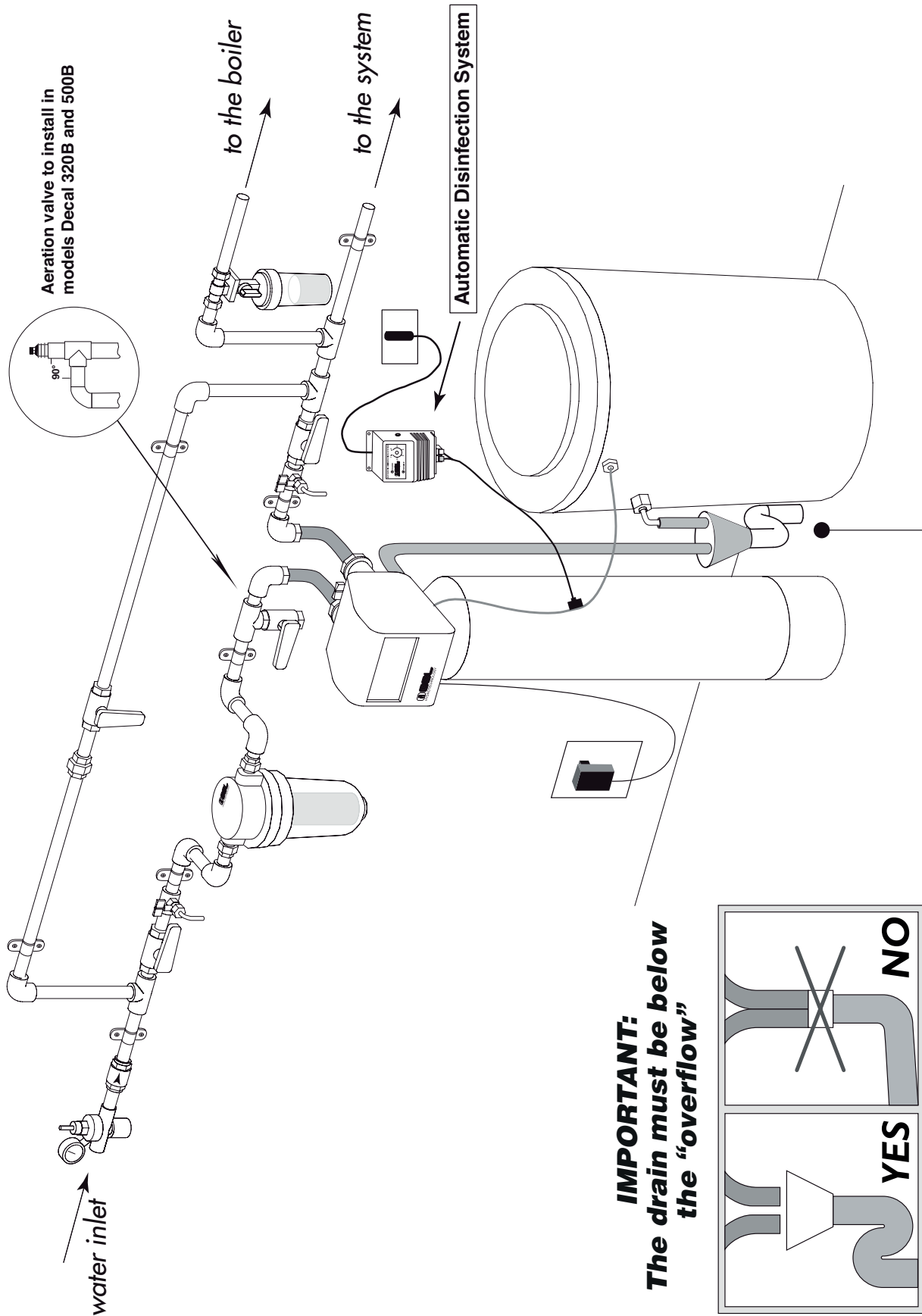

1.1 DESCRIPTION OF COMPONENTS

Disinfection system is used in all water softeners (up to max. 300 l. of resin) as a system for resins disinfection.

Disinfection system is made up of a junction box, an electrode holding union T, electrodes fitted with connection cable and two pipe locking rings.

1.2 SETTINGS

To start up a softener fitted with Disinfection System, check the device is properly adjusted according to the table below.

POSITION	2	4	6	8	10
MAX. LITRES OF RESIN	30	60	100	200	300

2. EXPLODED VIEW

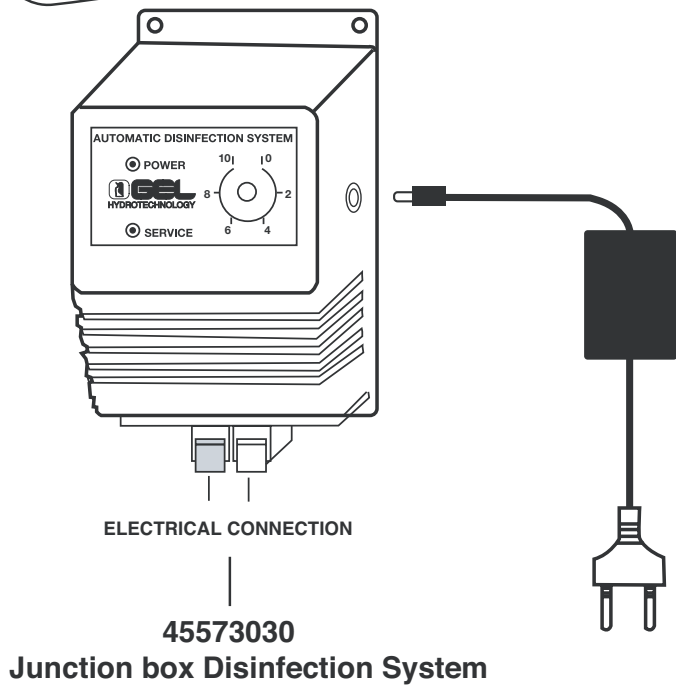
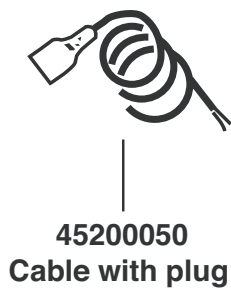
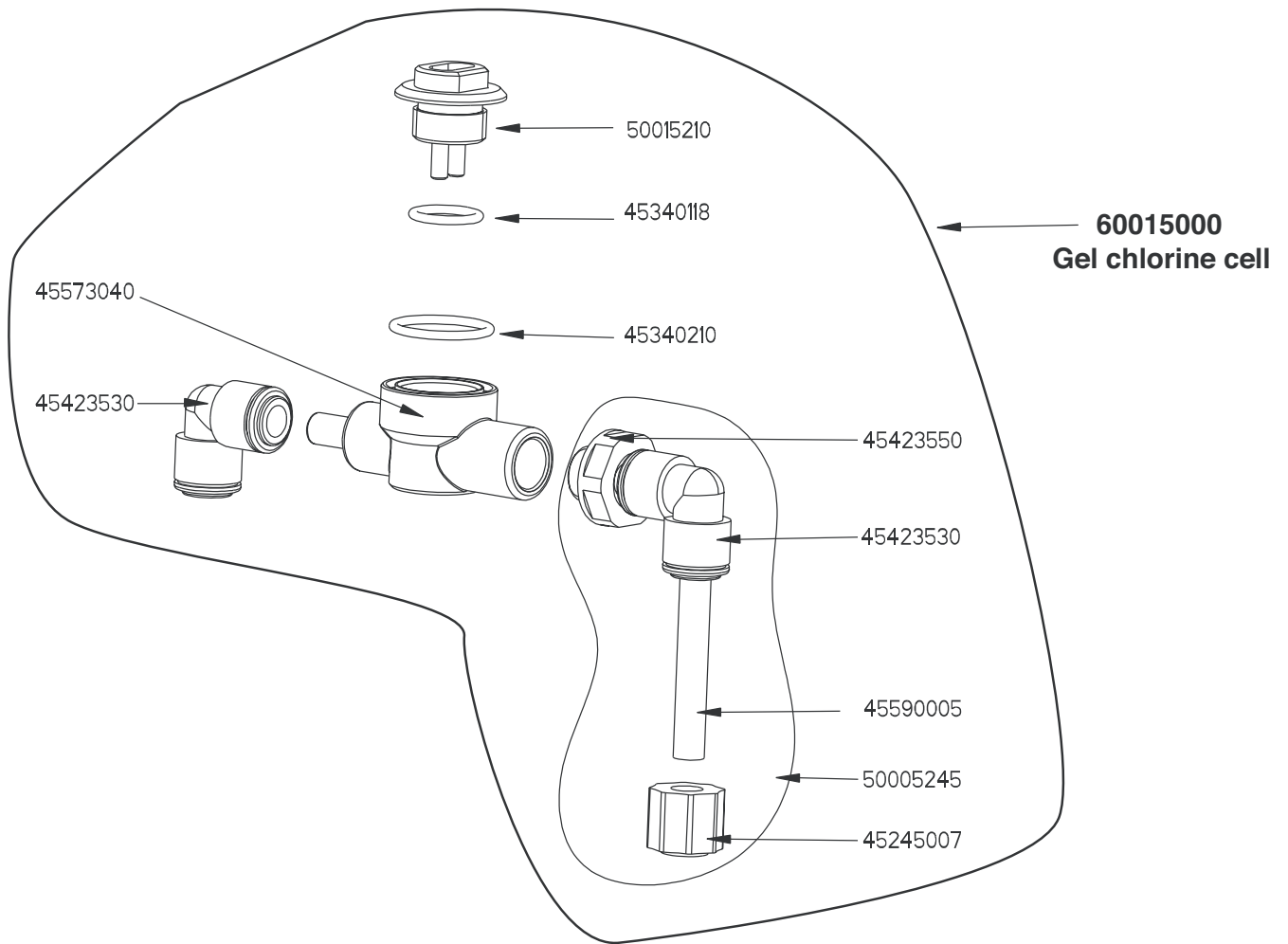

3. BEFORE STARTING CHECK THAT ...

- 1) A socket 230 V is available.
- 2) The union T is installed properly on the brine suction pipe;
- 3) The electrodes are properly connected;
- 4) The union T does not suck air from the from the locking rings.

4. TROUBLESHOOTING

PROBLEM	POSSIBLE CAUSES	SOLUTIONS
System does not produce chlorine	No power supply	Make sure that system is plugged in and voltage is 230V \pm 10%
	Electrodes oxidised	Clean electrodes; if necessary replace electrodes and connection cable
Softener does not suck brine	Fittings not properly tightened	Disassemble and tighten properly
	Union T broken	Disassemble and replace