

# Wall sockets

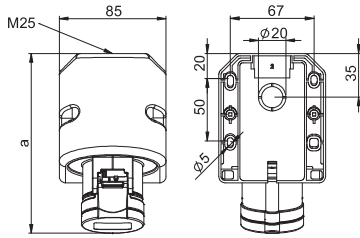

b=height  
angle=15°

## Wall socket IP44

Poles	16 Amp			32 Amp		
	3	4	5	3	4	5
a	142	145	144	155	155	157
b	97	98	104	106	106	111
M	25	25	25	25	25	25
Connection type: Screw terminal						
Wire flexible [mm <sup>2</sup> ]	1-2,5			2,5-6		
solid [mm <sup>2</sup> ]	1-4			2,5-10		
Contact screws [Ncm]	100 Ncm			110 Ncm		
Weight [g]	226	240	259	274	291	318

- with screw terminals
- housing material: PA6
- contacts: brass
- to order nickel-plated contacts please add a "v" e.g. 115-6v
- top and rear entry
- incl. threaded cable grommet

**IP44** splashproof

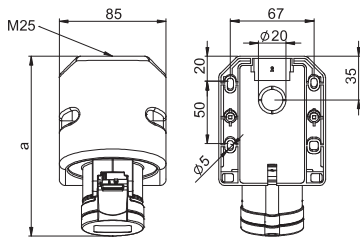

b=height  
angle=15°

## Turbo Twist Wall socket IP44

Poles	16 Amp			32 Amp		
	3	4	5	3	4	5
a	142	145	144	155	155	157
b	97	98	104	106	106	111
M	25	25	25	25	25	25
Connection type: Screwless terminal						
Wire flexible [mm <sup>2</sup> ]	1-2,5			2,5-6		
solid [mm <sup>2</sup> ]	1-4			2,5-10		
Weight [g]	228	240	264	274	290	319

- screwless connection technology
- housing material: PA6
- contacts: brass
- to order nickel-plated contacts please add a "v" e.g. 115-6TTv
- top and rear entry
- incl. threaded cable grommet

**IP44** splashproof

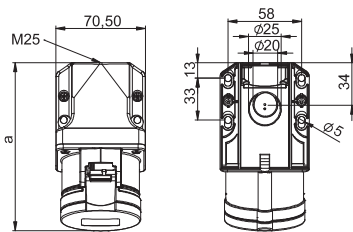

b=height  
angle=15°

## Wall socket IP44

Poles	16 Amp			32 Amp		
	3	4	5	3	4	5
a	132	133	133	145	145	145
b	94	97	100	103	103	107
M	25	25	25	25	25	25
Connection type: Screw terminal						
Wire flexible [mm <sup>2</sup> ]	1-2,5			2,5-6		
solid [mm <sup>2</sup> ]	1-4			2,5-10		
Contact screws [Ncm]	100 Ncm			110 Ncm		
Weight [g]	202	214	233	249	365	292

- with screw terminals
- housing material: PA6
- contacts: brass
- to order nickel-plated contacts please add a "v" e.g. 115-6kv
- to order Turbo Twist design (screwless connection technology) please add a „TT“ e.g. 115-6kTT
- top and rear entry
- incl. threaded cable grommet

**IP44** splashproof

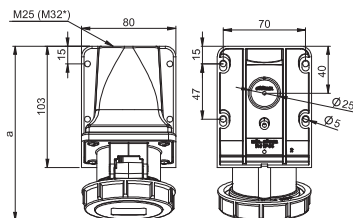

b=height  
angle=15°

## Wall socket IP67

Poles	16 Amp			32 Amp		
	3	4	5	3	4	5
a	146	148	148	161	161	163
b	96	99	102	108	108	112
M*	25	25	25	25	25	25
Connection type: Screw terminal						
Wire flexible [mm <sup>2</sup> ]	1-2,5			2,5-6		
solid [mm <sup>2</sup> ]	1-4			2,5-10		
Contact screws [Ncm]	100 Ncm			110 Ncm		
Weight [g]	226	241	275	298	314	351

- with screw terminals
- housing material: PA6
- contacts: brass
- to order nickel-plated contacts please add a "v" e.g. 1152-6v
- to order Turbo Twist design (screwless connection technology) please add a „TT“ e.g. 1152-6TT
- top and rear entry

**IP67** watertight

\*M32 optional on request available

**110V~**

50/60Hz  
4h

**230V~**

50/60Hz  
3p=6h  
4p+5p=9h

**400V~**

50/60Hz  
3p=9h  
4p+5p=6h

**500V~**

50/60Hz  
7h

**>50-  
500V~**

100-300Hz  
10h

**>50-  
500V~**

301-500Hz  
2h

Amp.	Poles	pack. unit	Cat.No.	Cat.No.	Cat.No.	Cat.No.	Cat.No.	Cat.No.
16	3	10	113-4	<b>113-6</b>	113-9	113-7	113-10	113-2
16	4	10	114-4	114-9	<b>114-6</b>	114-7	114-10	114-2
16	5	10	115-4	115-9	<b>115-6</b>	115-7	115-10	115-2
32	3	10	123-4	<b>123-6</b>	123-9	123-7	123-10	123-2
32	4	10	124-4	124-9	<b>124-6</b>	124-7	124-10	124-2
32	5	10	125-4	125-9	<b>125-6</b>	125-7	125-10	125-2



113-6

16	3	10	113-4TT	<b>113-6TT</b>	113-9TT			
16	4	10	114-4TT	114-9TT	<b>114-6TT</b>			
16	5	10	115-4TT	115-9TT	<b>115-6TT</b>			
32	3	10	123-4TT	<b>123-6TT</b>	123-9TT			
32	4	10	124-4TT	124-9TT	<b>124-6TT</b>			
32	5	10	125-4TT	125-9TT	<b>125-6TT</b>			



113-6TT

16	3	10	113-4k	<b>113-6k</b>	113-9k	113-7k	113-10k	113-2k
16	4	10	114-4k	114-9k	<b>114-6k</b>	114-7k	114-10k	114-2k
16	5	10	115-4k	115-9k	<b>115-6k</b>	115-7k	115-10k	115-2k
32	3	10	123-4k	<b>123-6k</b>	123-9k	123-7k	123-10k	123-2k
32	4	10	124-4k	124-9k	<b>124-6k</b>	124-7k	124-10k	124-2k
32	5	10	125-4k	125-9k	<b>125-6k</b>	125-7k	125-10k	125-2k



115-6k

16	3	5	1132-4	<b>1132-6</b>	1132-9	1132-7	1132-10	1132-2
16	4	5	1142-4	1142-9	<b>1142-6</b>	1142-7	1142-10	1142-2
16	5	5	1152-4	1152-9	<b>1152-6</b>	1152-7	1152-10	1152-2
32	3	5	1232-4	<b>1232-6</b>	1232-9	1232-7	1232-10	1232-2
32	4	5	1242-4	1242-9	<b>1242-6</b>	1242-7	1242-10	1242-2
32	5	5	1252-4	1252-9	<b>1252-6</b>	1252-7	1252-10	1252-2



1152-6

- 
- 
- 
- 
- 
- 
- 
- 
- 
-