



SCALA2





<http://qr.grundfos.com/i/scala2install>

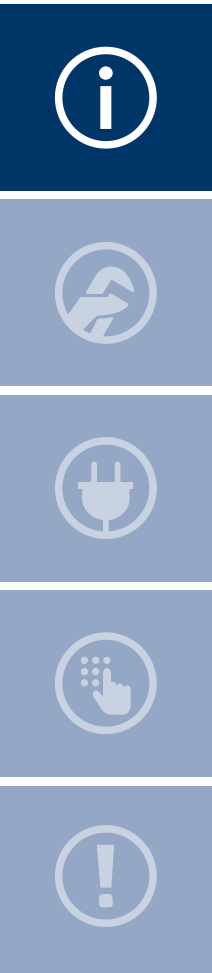

be
think
innovate



GRUNDFOS 



PN10: 10 bar/1.0 MPa 

Min./Max.
0 °C - + 45 °C
32 °F - + 113 °F 

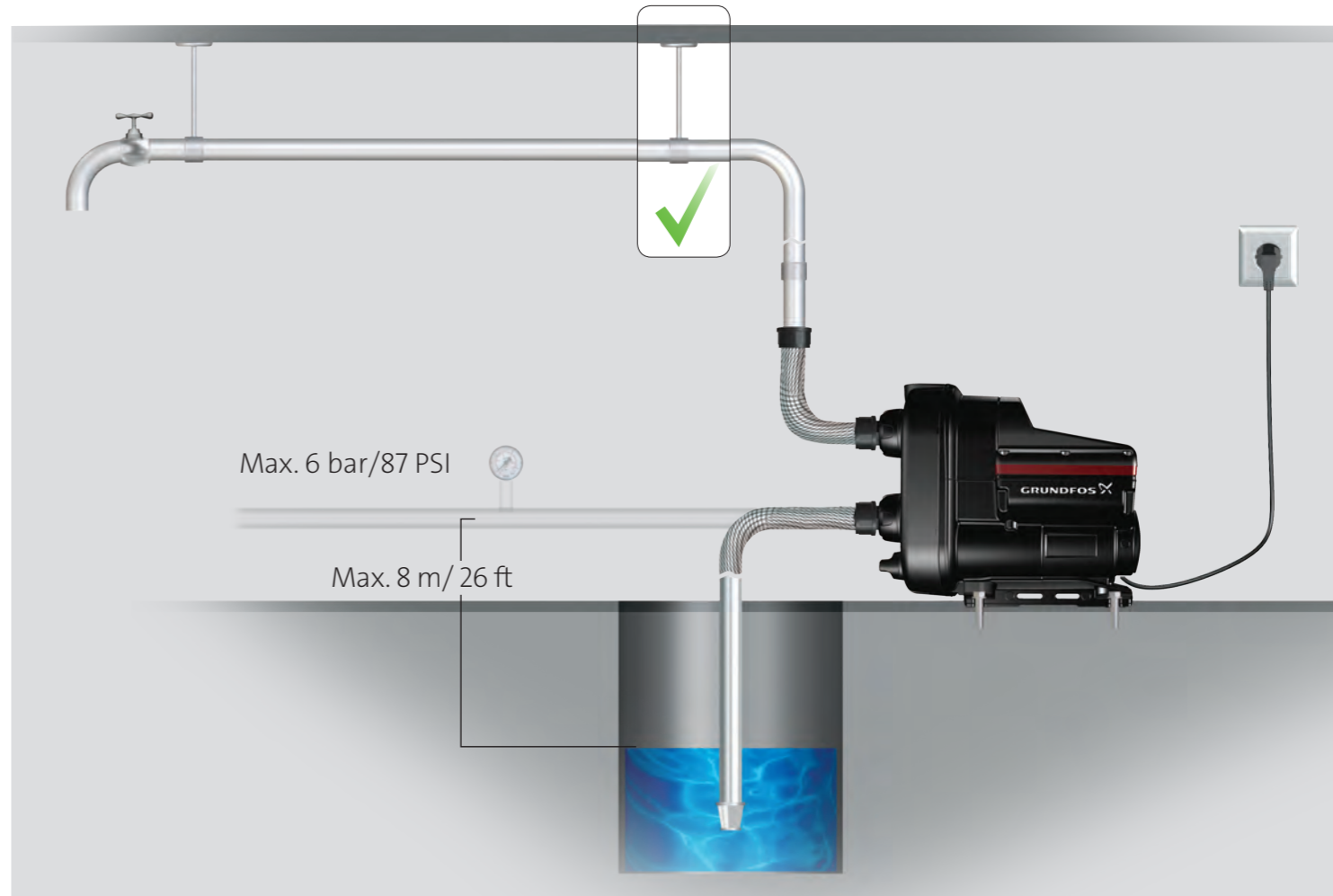
 Max.
1 x 208-230 V, 60 Hz: 45°C / 113°F 
1 x 115 V, 60 Hz: 45°C / 113°F
1 x 200 - 240 V, 50 / 60Hz: 55°C / 131°F



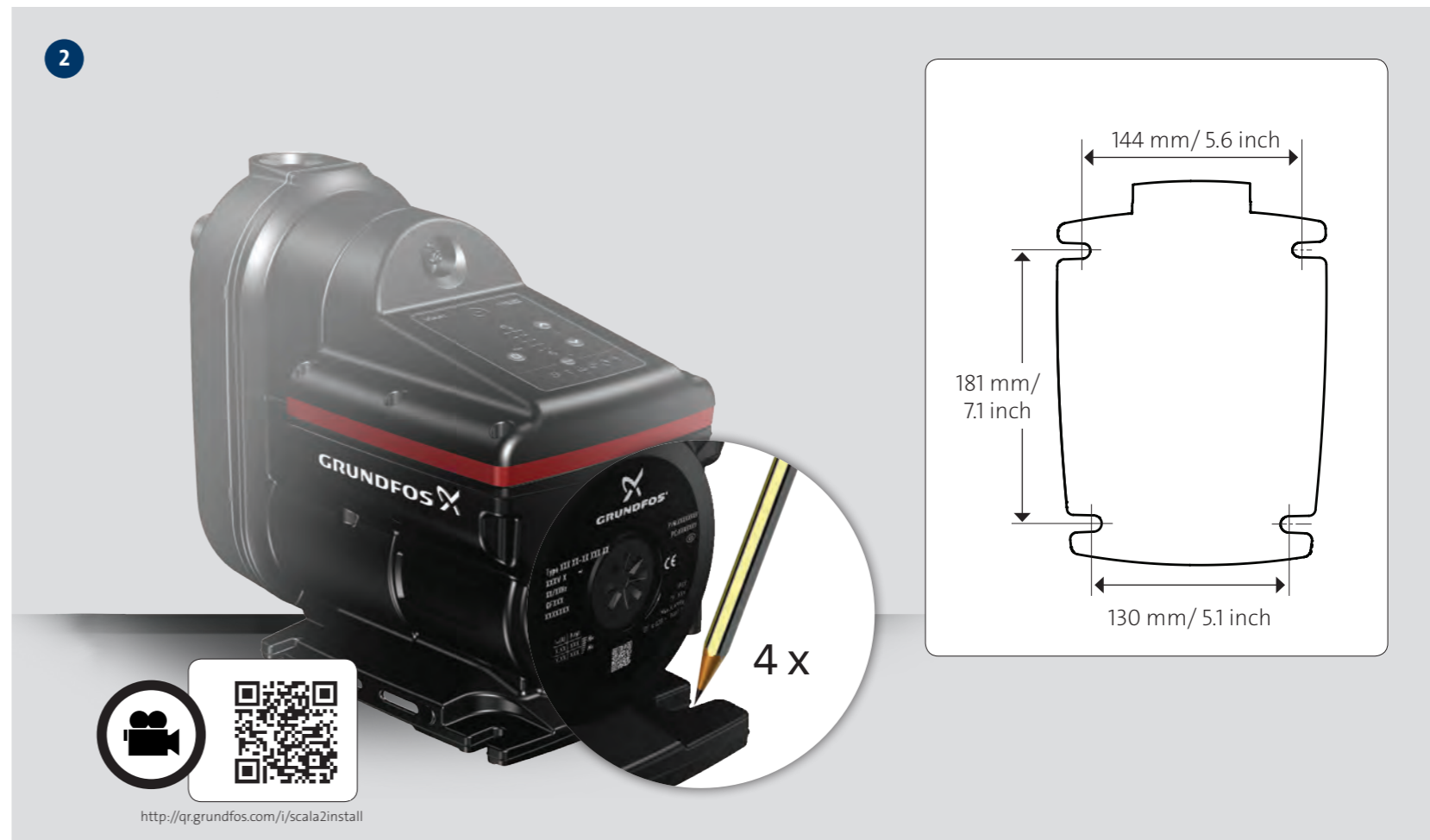
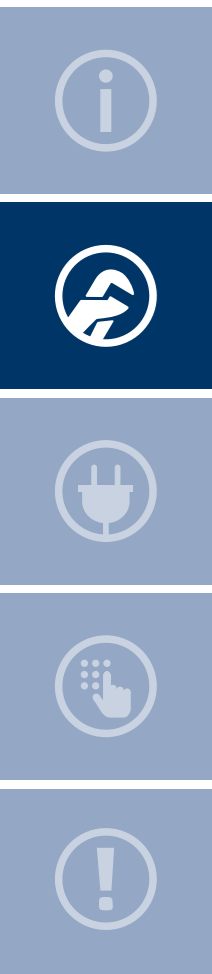

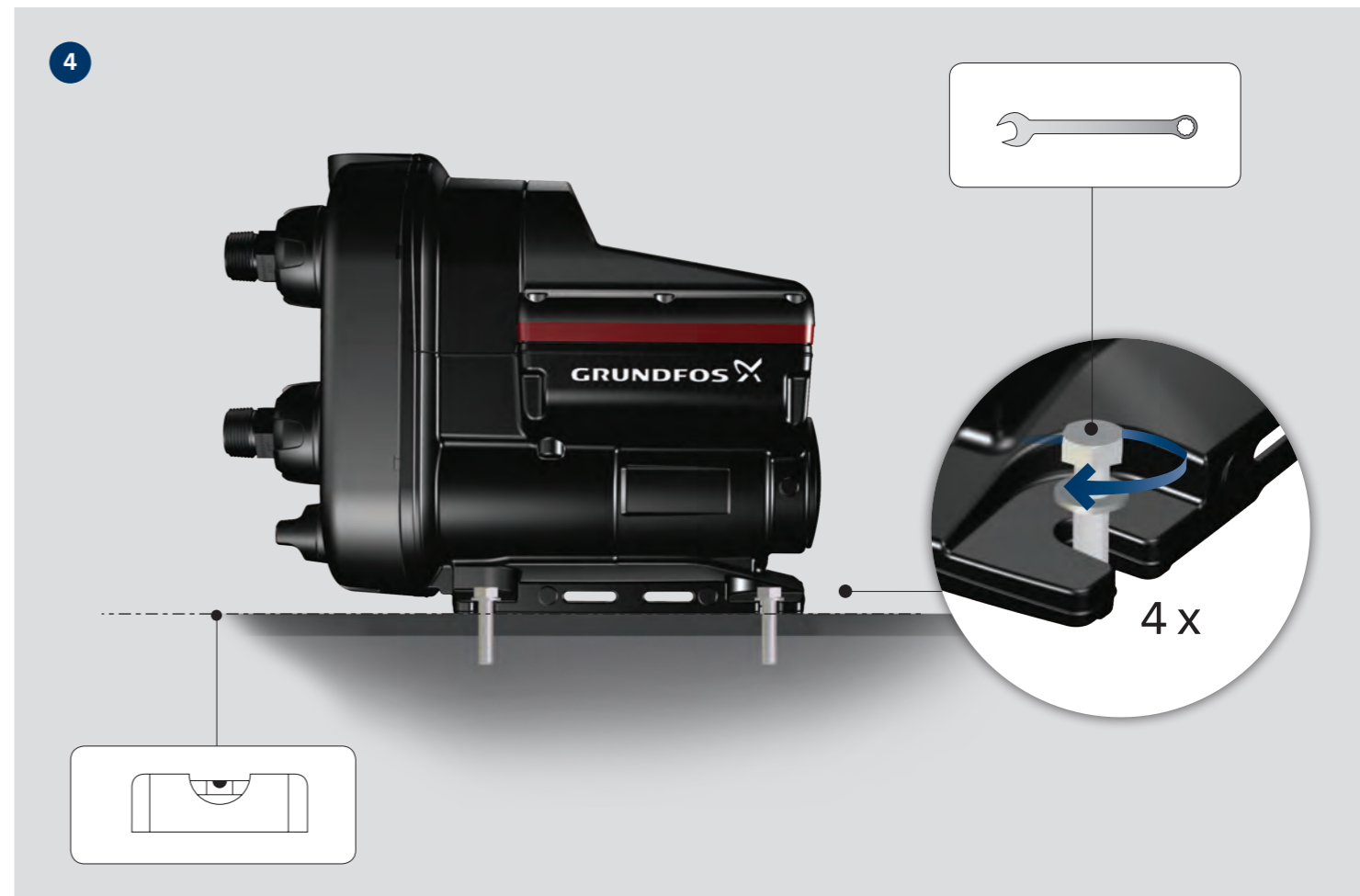
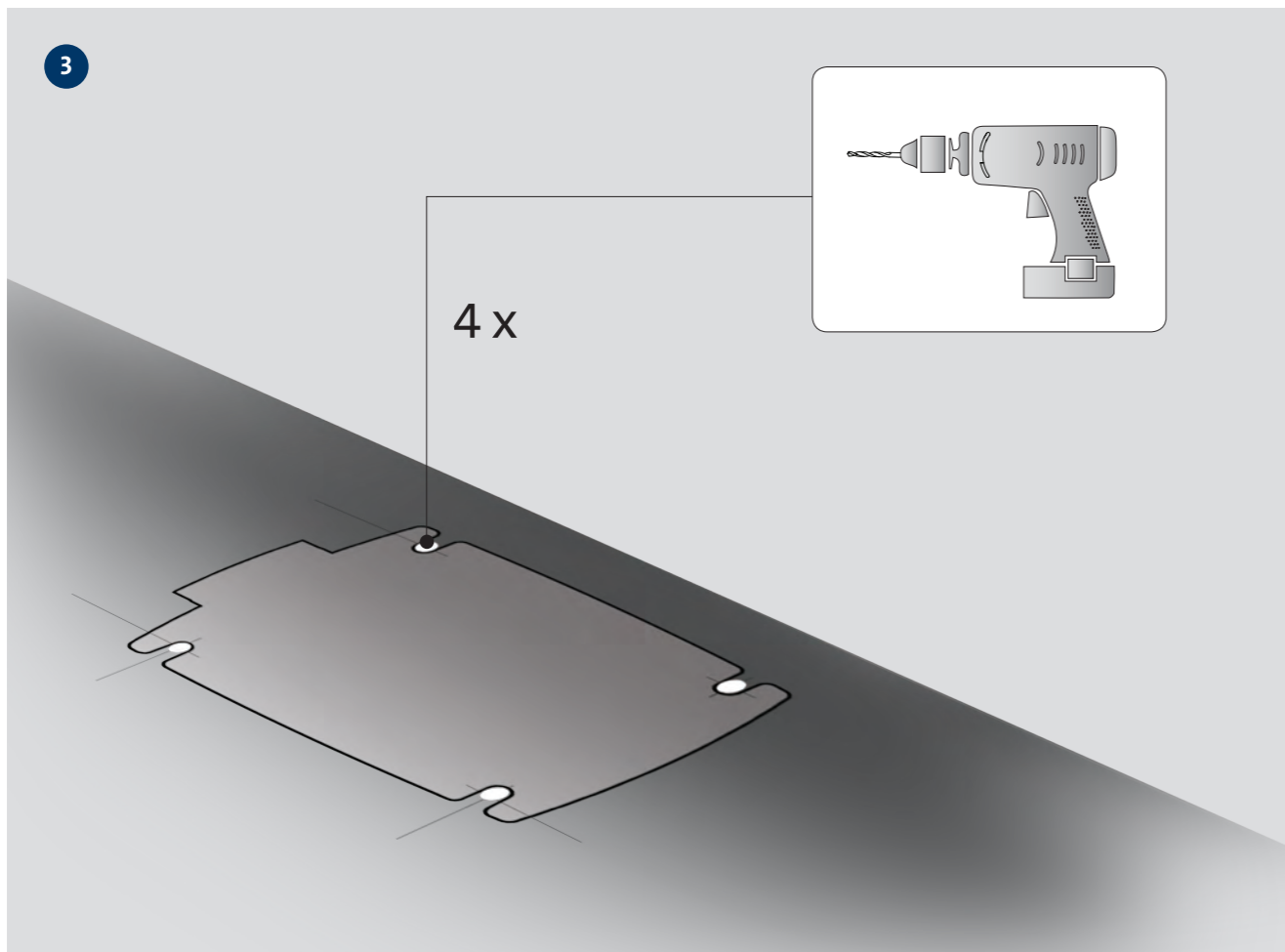
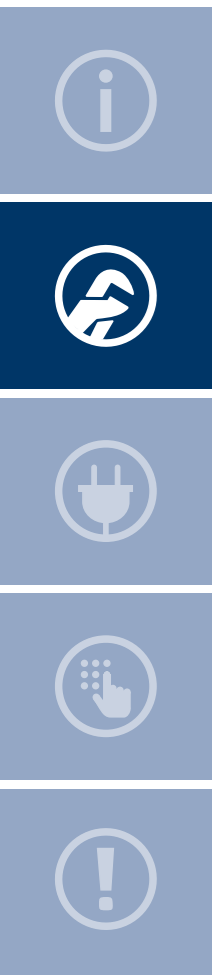

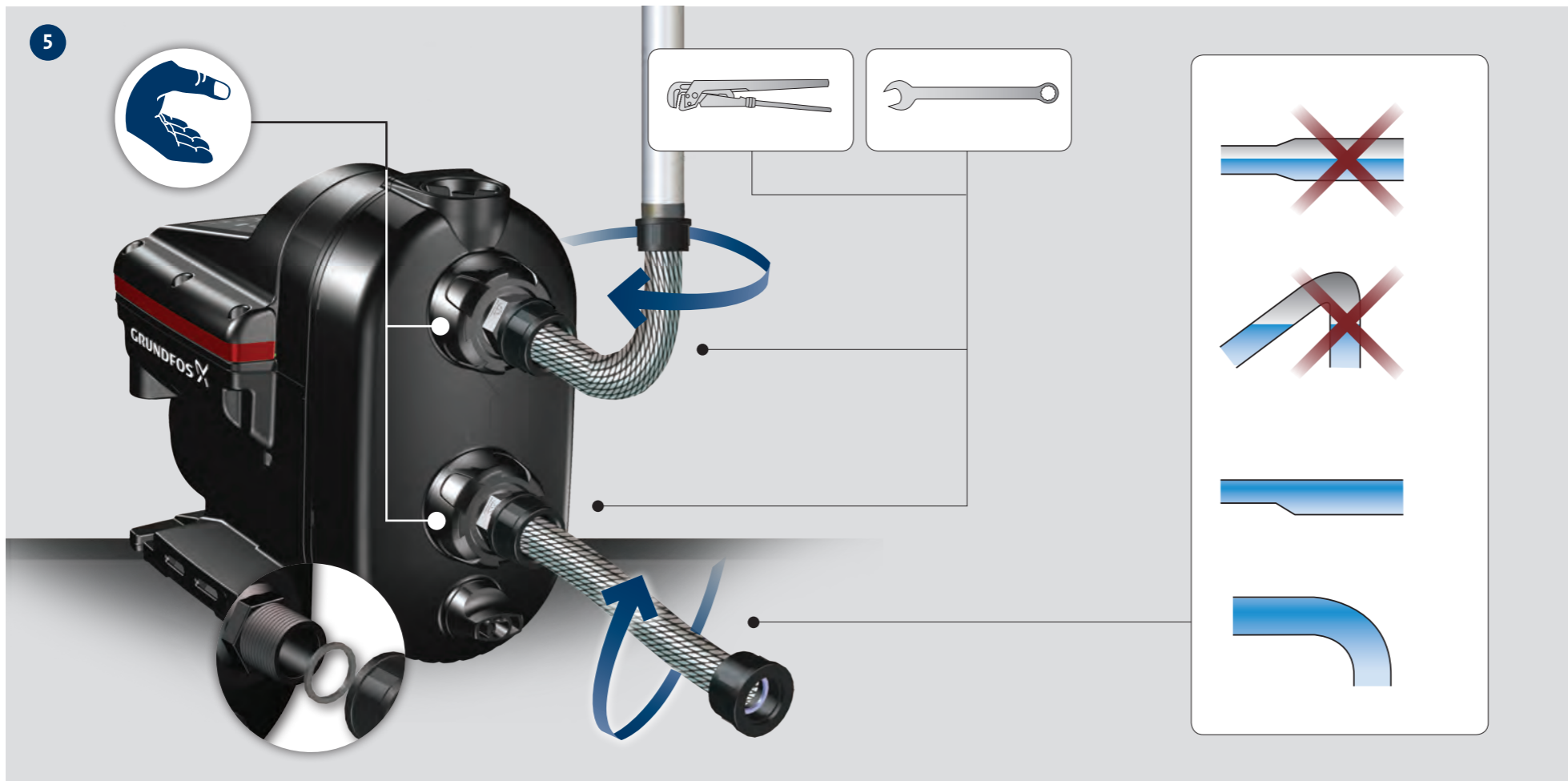
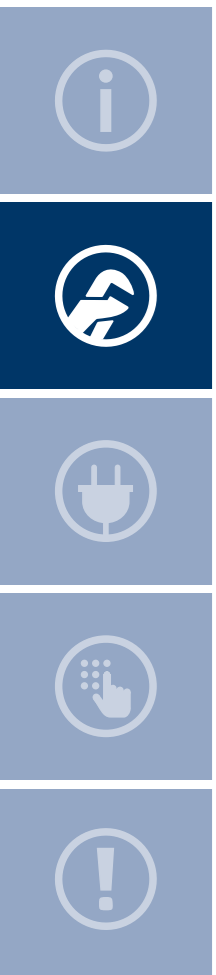

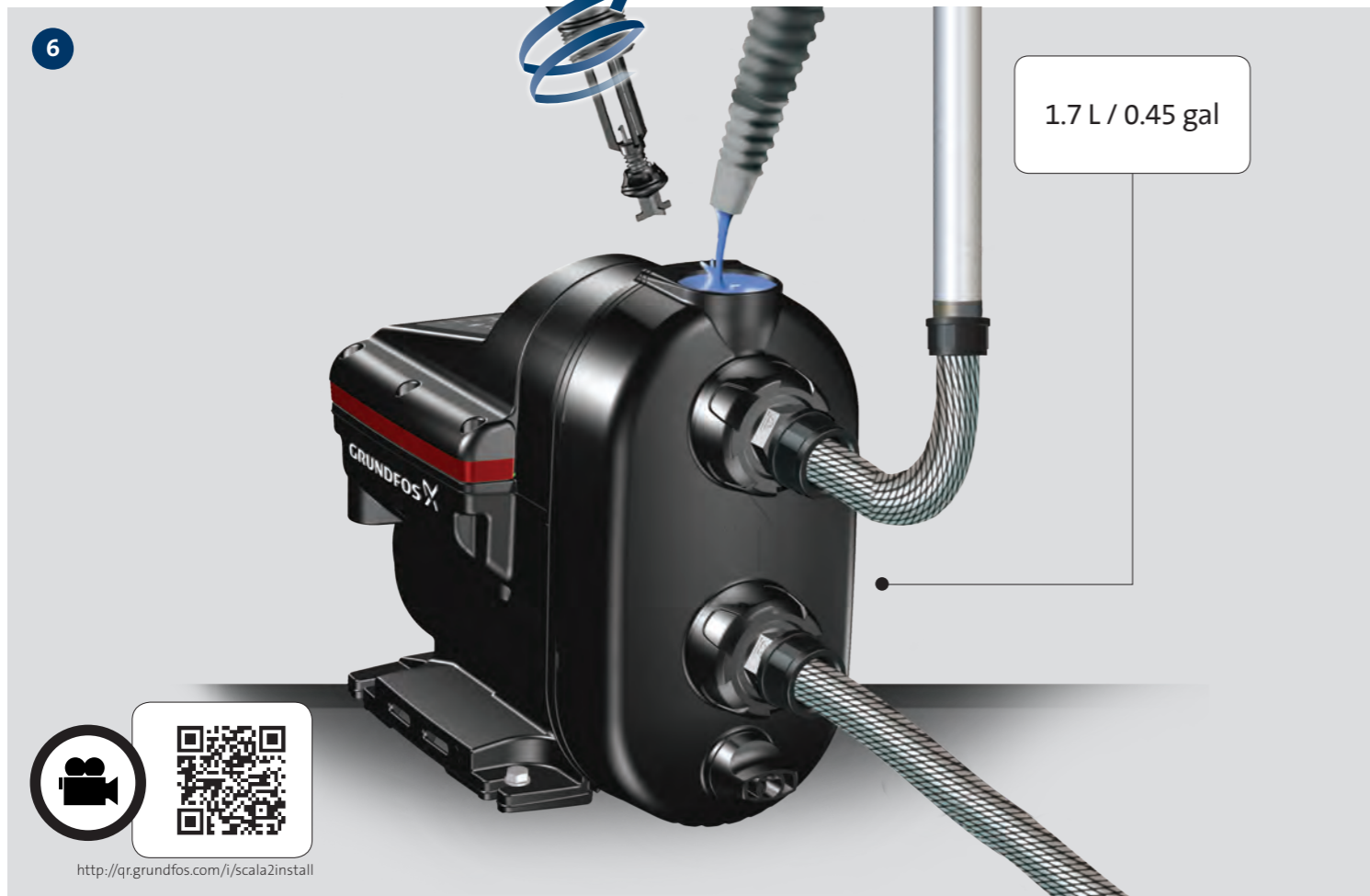
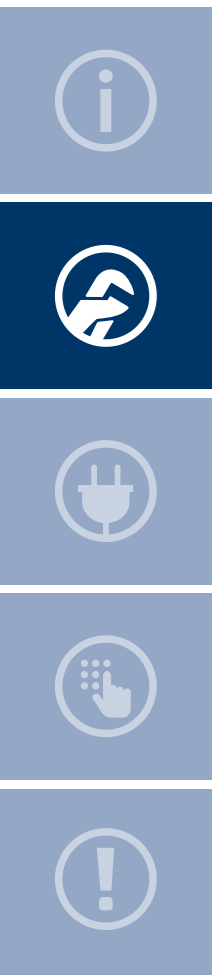

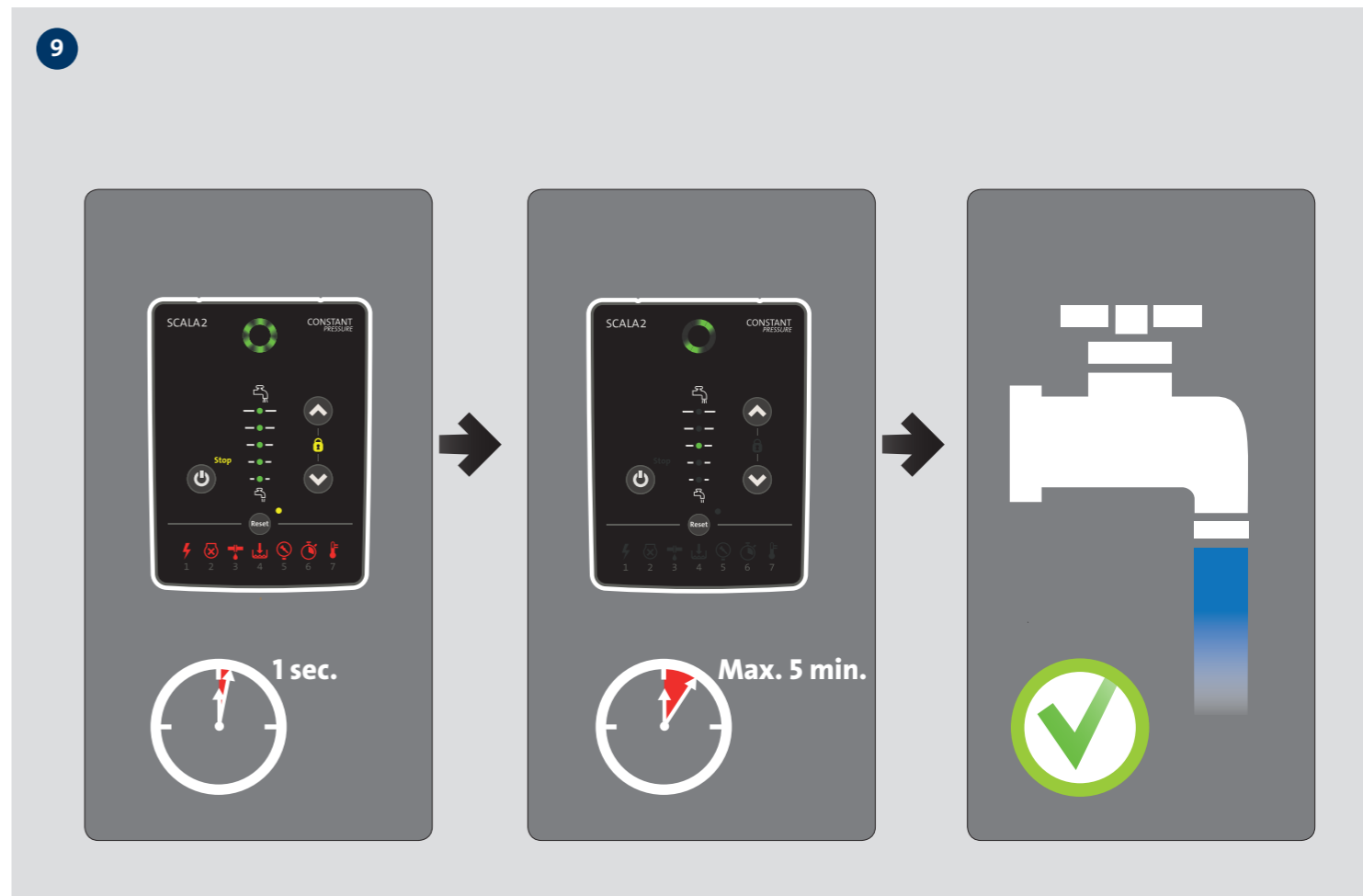
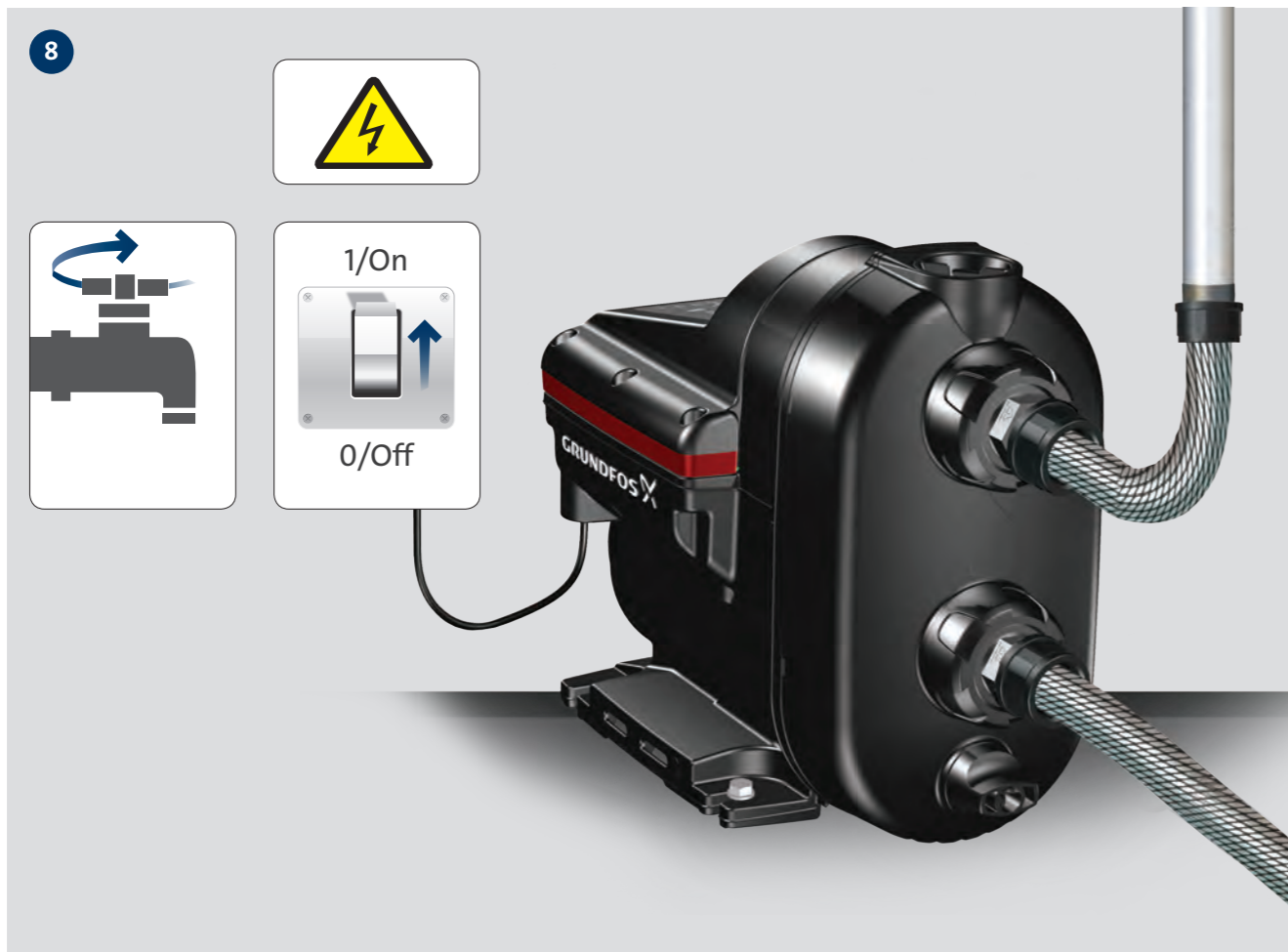
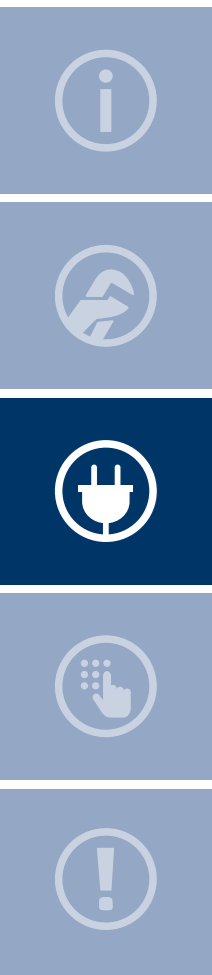

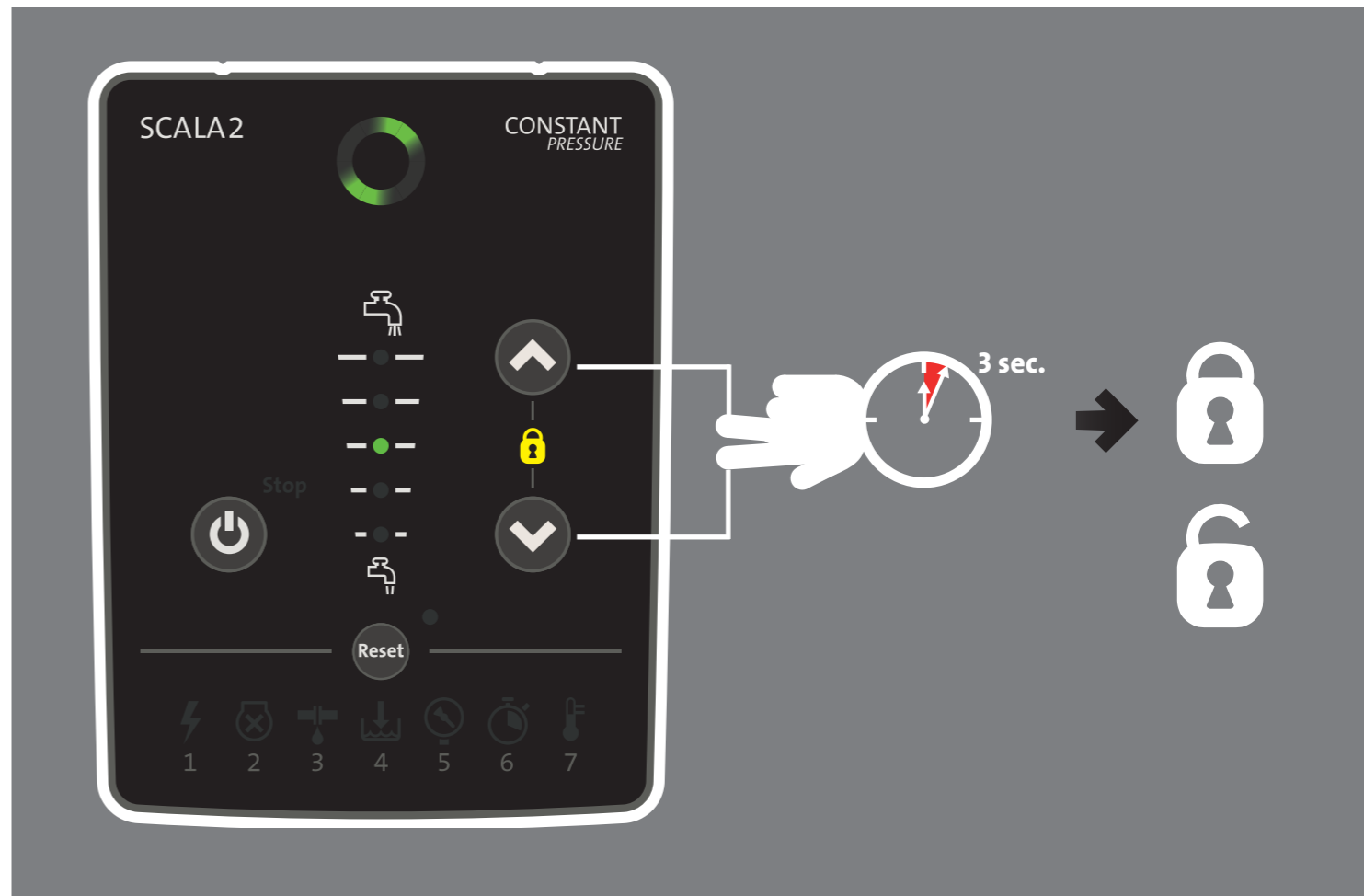
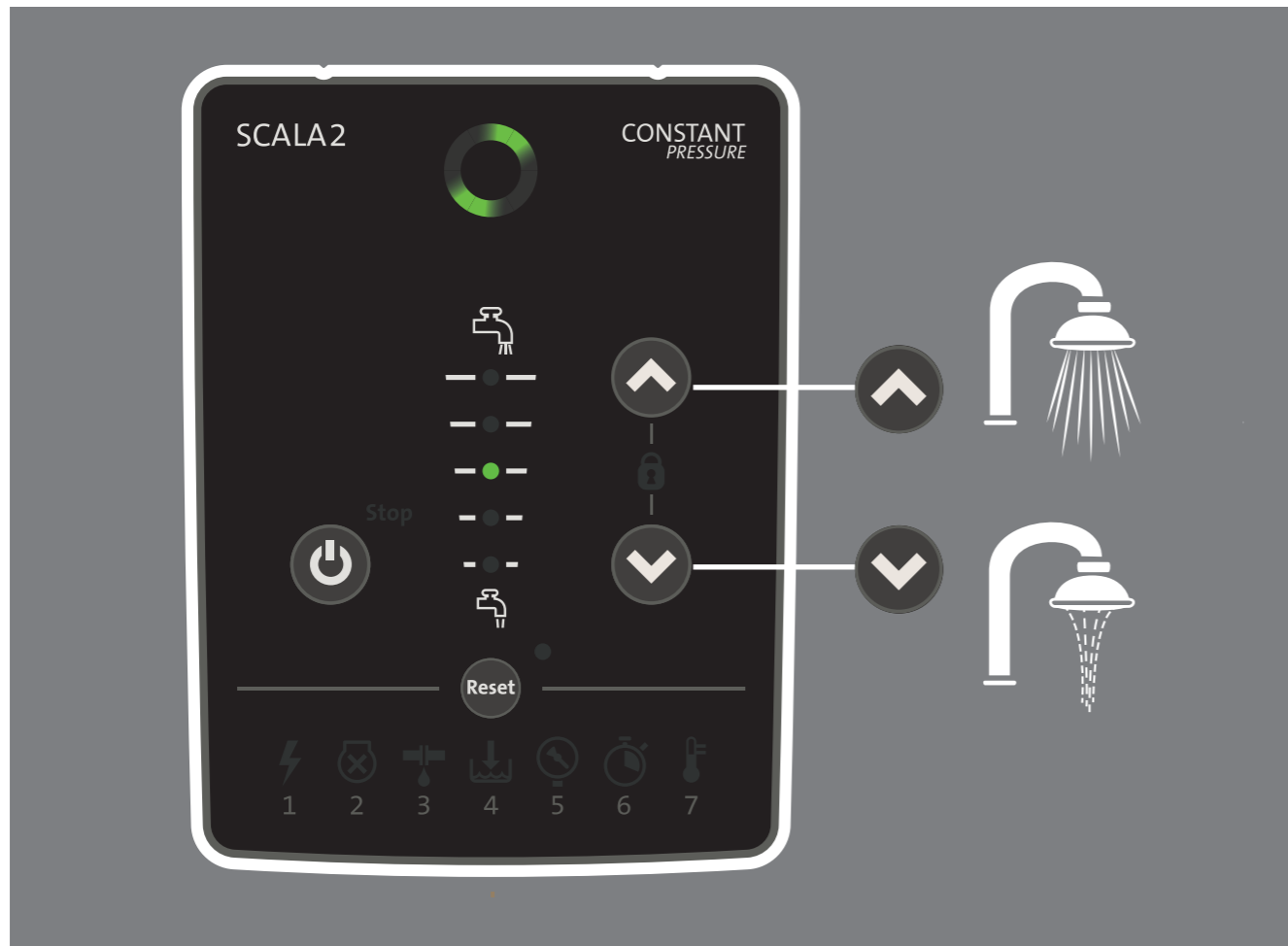
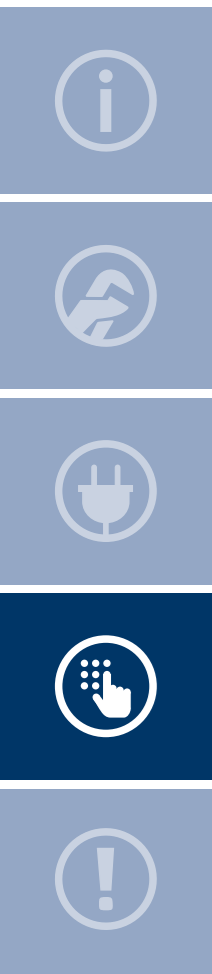

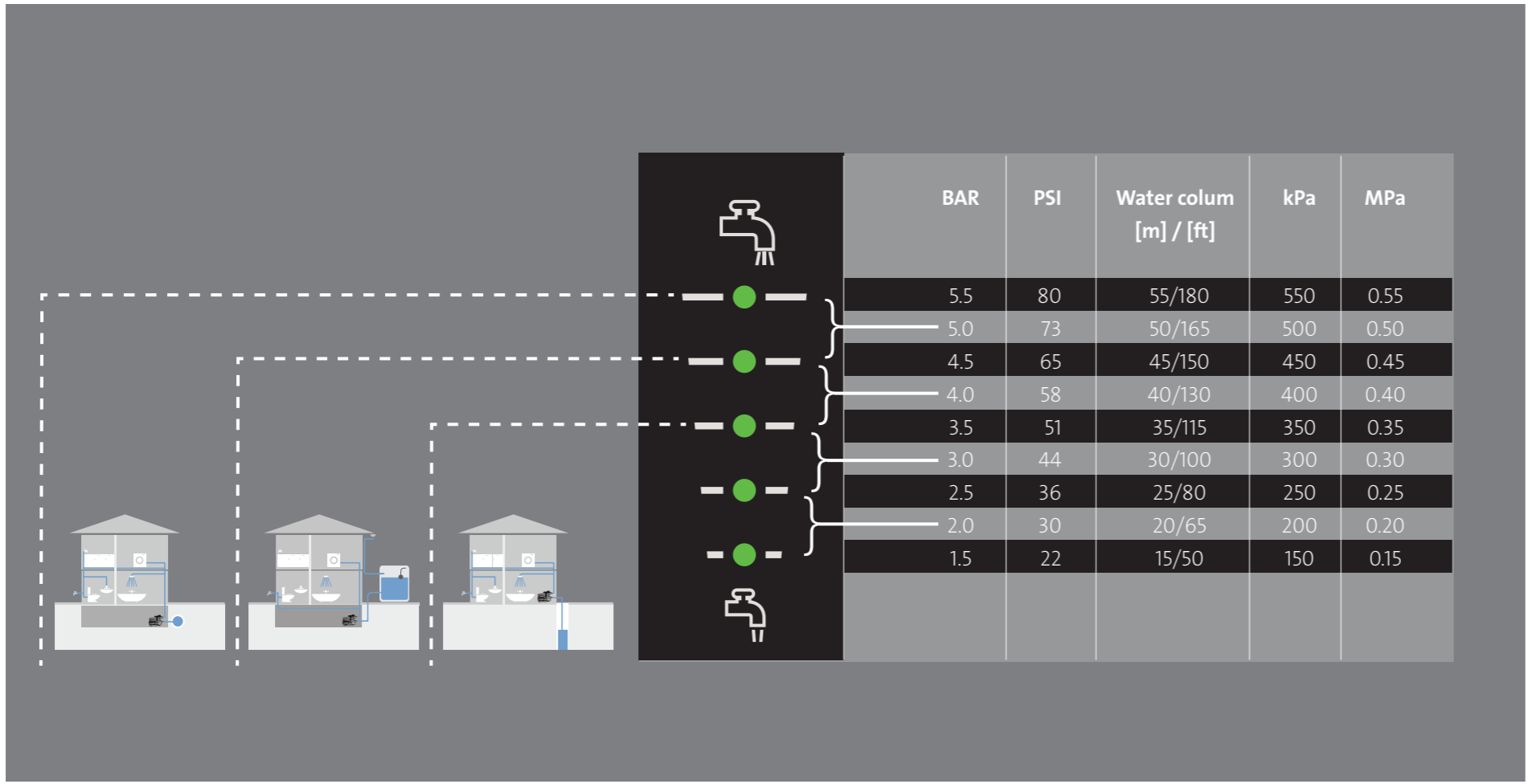
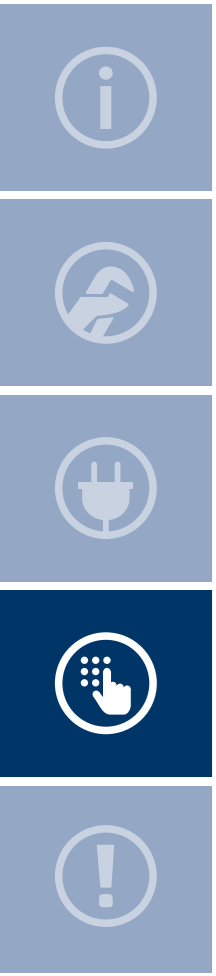

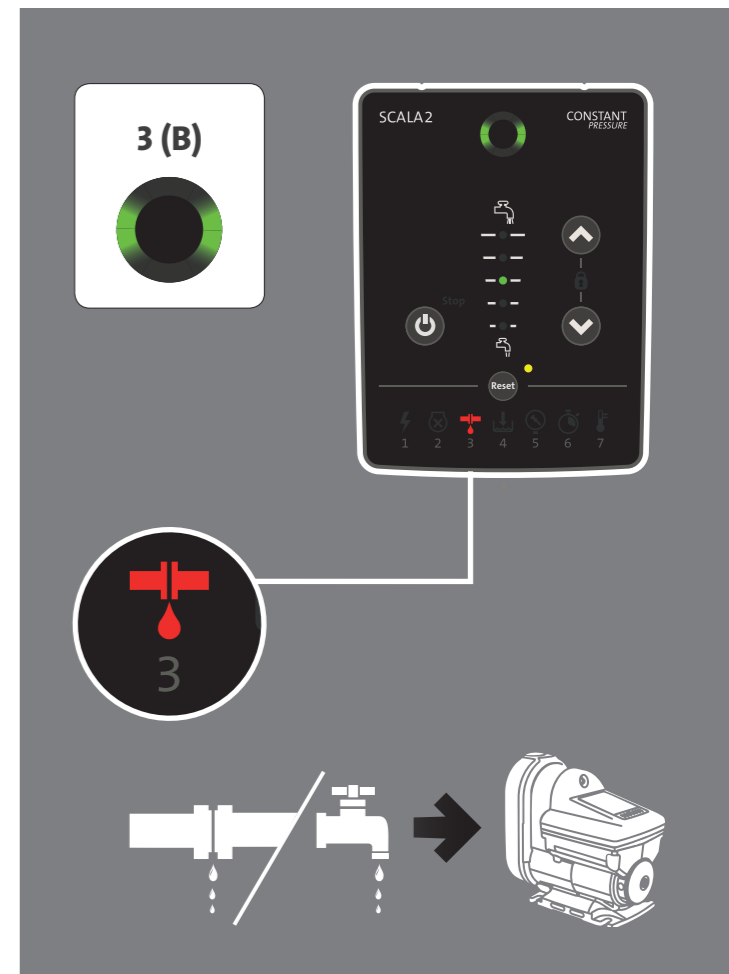
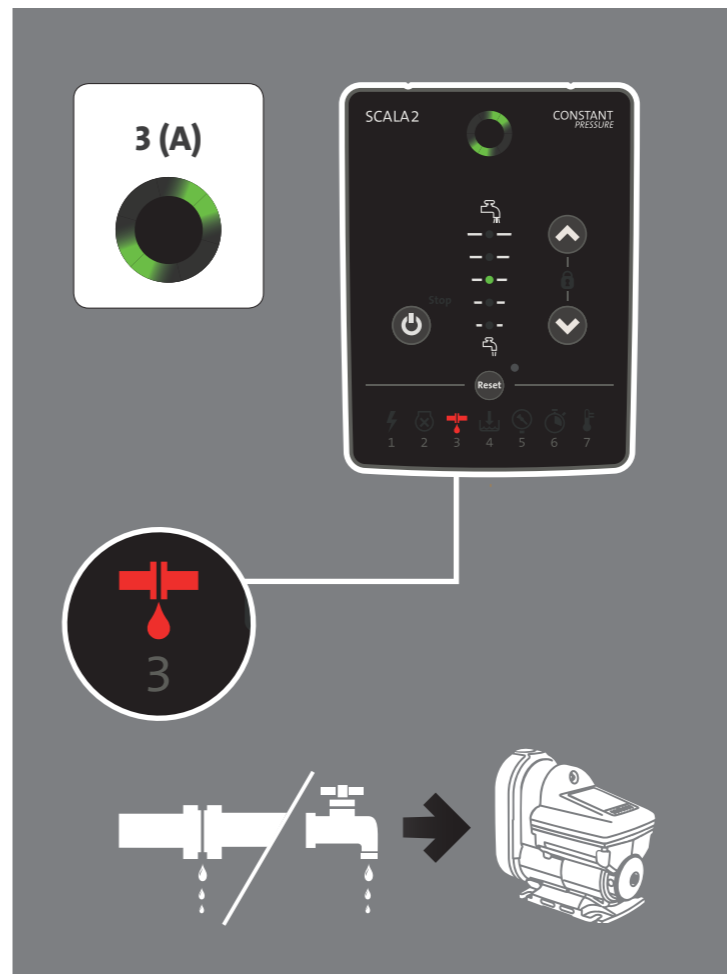
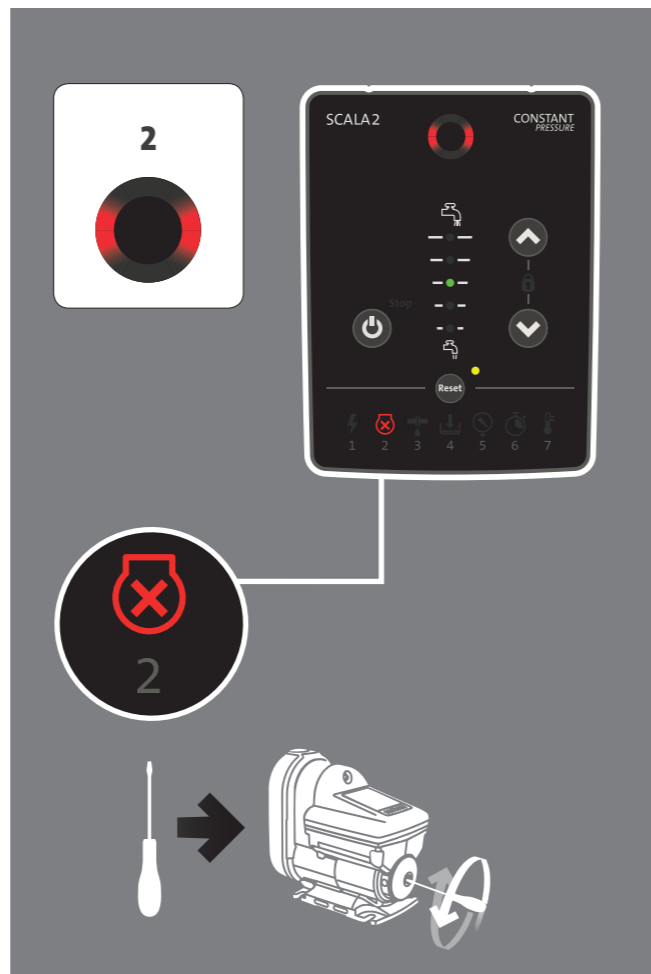
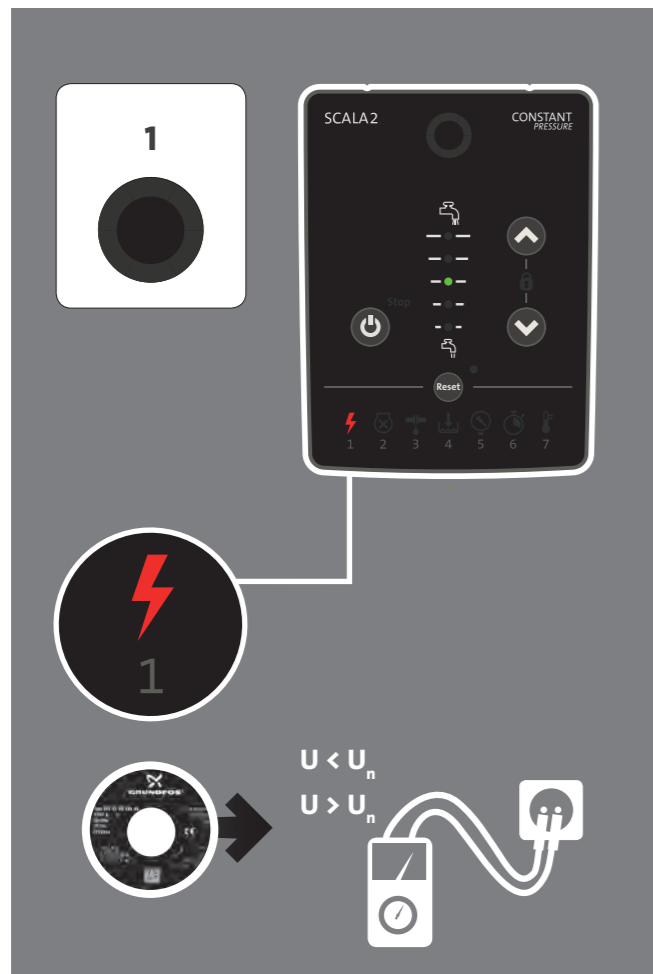
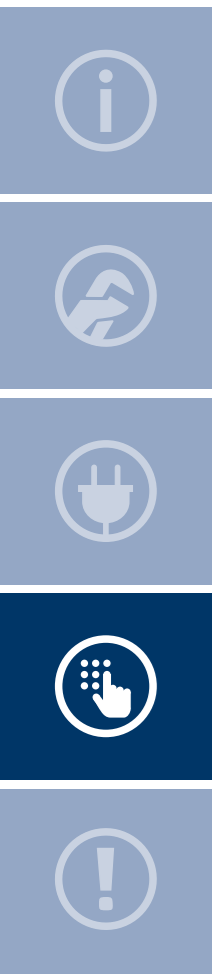

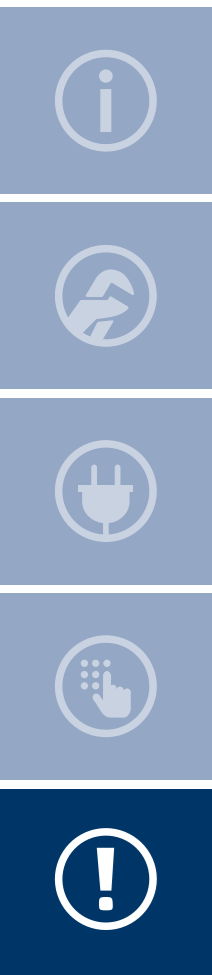

4

SCALA2 CONSTANT PRESSURE

4

$p > p_{\text{sys. max.}}$

$P_{\text{set}} > H_{\text{max}}$

5

SCALA2 CONSTANT PRESSURE

5

$p > p_{\text{sys. max.}}$

$P_{\text{set}} > H_{\text{max}}$

6

SCALA2 CONSTANT PRESSURE

6

0.5 hr.

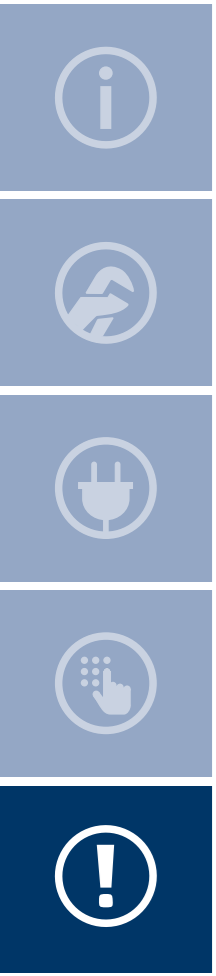

7 (A)

SCALA2 CONSTANT PRESSURE

22

7 (B)

SCALA2 CONSTANT PRESSURE

23

Legend icons: 1 (lightning bolt), 2 (shield with X), 3 (water drop), 4 (water level), 5 (hand with arrow), 6 (stopwatch), 7 (thermometer).

net.grundfos.com/qr/i/98880508

be think innovate

98501666 0416

ECM: 1183347

GRUNDFOS Holding A/S
Poul Due Jensens Vej 7
DK-8850 Bjerringbro
Tel: +45 87 50 14 00
www.grundfos.com

GRUNDFOS 

The name Grundfos, the Grundfos logo, and be think innovate are registered trademarks owned by Grundfos Holding A/S or Grundfos A/S, Denmark. All rights reserved worldwide.