

**Sirius New W3002**



universal  
round edges



flat  
sandwich

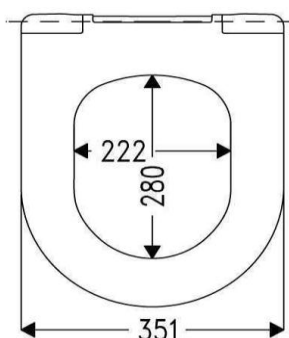

drawing

**Material** Urea 131.5 Duroplast  
**Seat weight** 1,64 kg  
**DIN 19516** fullfills WC-seat DIN 19516

hinge				packaging / palletisation
Code	Picture	Material	Fixation	
B2602W ArtNr. 407553		stainless steel 1.4301 sealing: PE EVA	BottomFix	7 pcs per outer carton 168 pcs per pallet

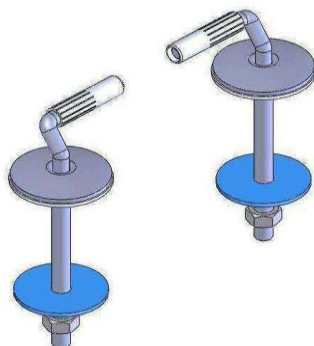

**buffer**

- DP 97  
4 pcs
- SP97  
4 pcs

**label**

