

DI GROOVED FITTINGS-GROOVED CONCENTRIC REDUCER

Type: 240

Doc No: DS-400-240-01-E

1.0 PRODUCT OVERVIEW

Grooved concentric reducer is used for groove pipeline connection. It is mainly applied in the pipeline diameter change. The center of the two ends of the connection is in the same straight line, which can change the flow rate.



Dimensions:

1 1/4"(DN32)– 12"(DN300)

Design Standard:

ISO6182, AWWA C606, GB 5135.11

Connection Standard:

ASME B36.10, ASTM A53-A53M, ISO 4200

Working Pressure:

175PSI-500PSI

Application:

The grooved concentric reducer product is suitable for medium and low pressure pipeline systems with nominal pressure 175-500 PSI, nominal size DN32-DN300, temperature range of - 20 °C-+180°C, which are widely applied in water supply and drainage, fire-fighting, air conditioning, etc.

Pipe Material:

Welded and seamless rolled steel pipes according to ASME B36.10, ASTM A53-A53M, ISO 4200, GB/T 21835

Surface Treatment:

- Electrophoretic painting
- Epoxy power painting
- Hot-dip galvanizing
- Black
- Others would be available upon clients' detailed request

2.0 APPROVALS



3.0 SPECIFICATIONS-MATERIAL

Ductile iron according to ASTM A536, grade 65-45-12. The nodularity is more than 90%, ensuring excellent physical and mechanical properties.

4.0 DIMENSIONS AND PERFORMANCE

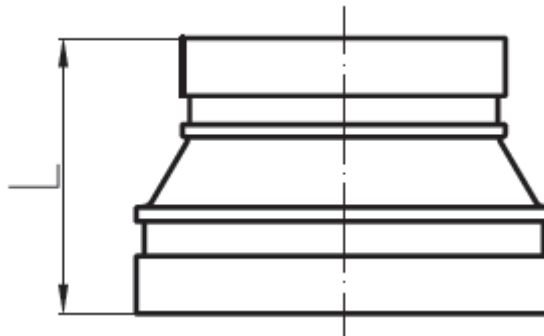

Nominal Size	Pipe O.D.	Working Pressure PSI/MPa	Dimensions
			L mm/in
32X25 1 ¹ / ₄ X1	42.4X33.7 1.660X1.315	500 3.45	64 2.5
40X25 1 ¹ / ₂ X1	48.3X33.7 1.900X1.315	500 3.45	64 2.5
40X32 1 ¹ / ₂ X1 ¹ / ₄	48.3X42.4 1.900X1.660	500 3.45	64 2.5
50X25 2X1	60.3X33.7 2.375X1.315	500 3.45	64 2.5

50X32 2X1¼	60.3X42.4 2.375X1.660	500 3.45	64 2.5
50X40 2X1½	60.3X48.3 2.375X1.900	500 3.45	64 2.5
65X25 2½X1	73.0X33.7 2.875X1.315	500 3.45	64 2.5
65X32 2½X1¼	73.0X42.4 2.875X1.660	500 3.45	64 2.5
65X40 2½X1½	73.0X48.3 2.875X1.900	500 3.45	64 2.5
65X50 2½X2	73.0X60.3 2.875X2.375	500 3.45	64 2.5
65X25 2½X1	76.1 X33.7 3.000X1.315	500 3.45	64 2.5
65X32 2½X1¼	76.1X42.4 3.000X1.660	500 3.45	64 2.5
65X40 2½X1½	76.1X48.3 3.000X1.900	500 3.45	64 2.5
65X50 2½X2	76.1X60.3 3.000X2.375	500 3.45	64 2.5
80X25 3X1	88.9X33.7 3.500X1.315	500 3.45	64 2.5
80X32 3X1¼	88.9X42.4 3.500X1.660	500 3.45	64 2.5
80X40 3X1½	88.9X48.3 3.500X1.900	500 3.45	64 2.5
80X50 3X2	88.9X60.3 3.500X2.375	500 3.45	64 2.5
80X65 3X2½	88.9X73.0 3.500X2.875	500 3.45	64 2.5
Nominal	Pipe	Working Pressure	Dimensions
Size	O.D.		L
mm/in	mm/in		mm/in
80X65 3X2½	88.9X76.1 3.500X3.000	500 3.45	64 2.5
100X50 4X2	108.0X60.3 4.250X2.375	500 3.45	76 3
100X65 4X2½	108.0X73.0 4.250X2.875	500 3.45	76 3
100X65 4X2½	108.0X76.1 4.250X3.000	500 3.45	76 3
100X80 4X3	108.0X88.9 4.250X3.500	500 3.45	76 3
100X32 4X1¼	114.3X42.4 4.500X1.660	500 3.45	76 3
100X40 4X1½	114.3X48.3 4.500X1.900	500 3.45	76 3

100X50 4X2	114.3X60.3 4.500X2.375	500 3.45	76 3
100X65 4X2½	114.3X73.0 4.500X2.875	500 3.45	76 3
100X65 4X2½	114.3X76.1 4.500X3.000	500 3.45	76 3
100X80 4X3	114.3X88.9 4.500X3.500	500 3.45	76 3
125X100 5X4	133.0X108.0 5.250X4.250	500 3.45	89 3.5
125X100 15X4	133.0X114.3 5.250X4.500	500 3.45	89 3.5
125X50 5X2	139.7X60.3 5.500X2.375	500 3.45	89 3.5
125X65 5X2½	139.7X76.1 5.500X3.000	500 3.45	89 3.5
125X80 5X3	139.7X88.9 5.500X3.500	500 3.45	89 3.5
125X100 5X4	139.7X114.3 5.500X4.500	500 3.45	89 3.5
125X65 5X2½	141.3X73.0 5.563X2.875	500 3.45	89 3.5

Nominal Size mm/in	Pipe O.D. mm/in	Working Pressure	Dimensions
			L
		PSI/MPa	mm/in
125X80 5X3	141.3X88.9 5.563X3.500	500 3.45	89 3.5
125X100 5X4	141.3X114.3 5.563X4.500	500 3.45	89 3.5
150X50 6X2	159.0X60.3 6.250X2.375	500 3.45	102 4
150X65 159.0X2½	159.0X76.1 6.250X3.000	500 3.45	102 4
150X80 6X3	159.0X88.9 6.250X3.500	500 3.45	102 4
150X100 6X4	159.0X108 6.250X4.250	500 3.45	102 4
150X100 6X4	159.0X114.3 6.250X4.500	500 3.45	102 4
150X125 6X5	159.0X133.0 6.250X5.250	500 3.45	102 4
150X50 6X2	165.1X60.3 6.500X2.375	500 3.45	102 4
150X65	165.1X76.1	500	102

6X2½	6.500X3.000	3.45	4
150X80	165.1X88.9	500	102
6X3	6.500X3.500	3.45	4
150X100	165.1X108.0	500	102
6X4	6.500X4.250	3.45	4
150X100	165.1X114.3	500	102
6X4	6.500X4.500	3.45	4
150X125	165.1X139.7	500	102
6X5	6.500X5.500	3.45	4
150X125	165.1X141.3	500	102
6X5	6.500X5.563	3.45	4
150X50	168.3X60.3	500	102
6X2	6.625X2.375	3.45	4
150X65	168.3X73.0	500	102
6X2½	6.625X2.875	3.45	4
150X65	168.3X76.1	500	102
6X2½	6.625X3.000	3.45	4

Nominal Size mm/in	Pipe O.D. mm/in	Working Pressure PSI/MPa	Dimensions
			L
			mm/in
150X80	168.3X88.9	500	102
6X3	6.625X3.500	3.45	4
150X100	168.3X114.3	500	102
6X4	6.625X4.500	3.45	4
150X125	168.3X139.7	500	102
6X5	6.625X5.500	3.45	4
150X125	168.3X141.3	500	102
6X5	6.625X5.563	3.45	4
200X100	216.3X114.3	300	127
8X4	8.516X4.500	2.07	5
200X150	216.3X165.1	300	127
8X6	8.516X6.500	2.07	5
200X65	219.1X73.0	500	127
8X2½	8.625X2.875	3.45	5
200X80	219.1X88.9	500	127
8X3	8.625X3.500	3.45	5
200X100	219.1X108.0	300	127
8X4	8.625X4.250	2.07	5
200X100	219.1X114.3	500	127
8X4	8.625X4.500	3.45	5
200X125	219.1X139.7	300	127
8X5	8.625X5.500	2.07	5
200X125	219.1X141.3	500	127
8X5	8.625X5.563	3.45	5

200X150 8X6	219.1X159.0 8.625X6.250	300 2.07	127 5
200X150 8X6	219.1X165.1 8.625X6.500	300 2.07	127 5
200X150 8X6	219.1X168.3 8.625X6.625	500 3.45	127 5
250X150 10X6	273.0X159.0 10.750X6.250	300 2.07	152 6
250X150 10X6	273.0X165.1 10.750X6.500	300 2.075	152 6
250X150 10X6	273.0X168.3 10.750X6.625	300 2.07	152 6

Nominal Size	Pipe O.D.	Working Pressure	Dimensions
mm/in	mm/in		L
		PSI/MPa	mm/in
250X200 10X8	273.0X219.1 10.750X8.625	300 2.07	152 6
300X200 12X8	323.9X219.1 12.750X8.625	300 2.07	178 7
300X250 12X10	323.9X273.0 12.750X10.750	300 2.07	178 7

5.0 REFERENCE MATERIALS

Approved certification for Grooved Fittings and Couplings

I-JM-Grooved fitting: Installation Instructions for grooved fittings and couplings