

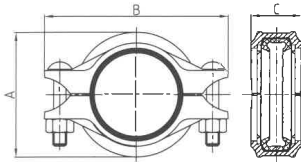

## Standard Rigid Coupling Model 1G & 1GS

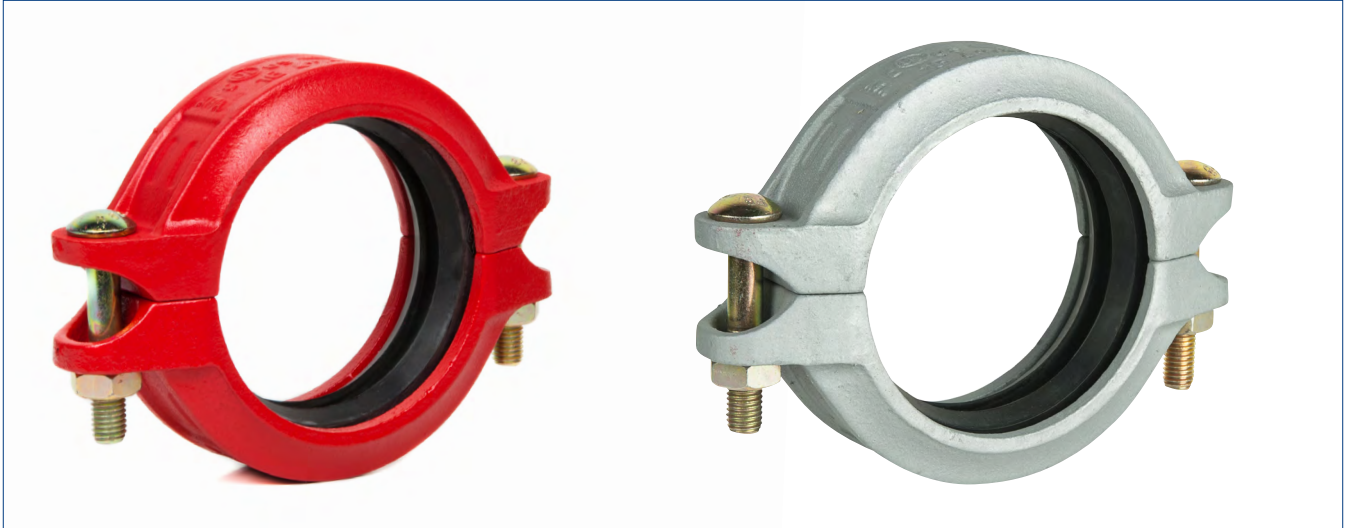

Model Number (Red Painted)	Model Number (Galvanised)	Nominal Size mm/in	Pipe O.D mm/in	Working Pressure PSI/MPa	Max End Load kN/Lbs	Pipe End Separation mm/in	Dimensions			Bolt Size No.-Size mm
							A mm/in	B mm/in	C mm/in	
RD1G033	RD1G033G	25 1	33.7 1.327	500 3.45	3.0/680	0-1.6 0-0.06	59 2.33	100 3.94	44 1.74	2 - 3/8 x 55 2 - M10X57
RD1G042	RD1G042G	32 1¼	42.4 1.669	500 3.45	4.8/1080	0-1.6 0-0.06	66 2.60	109.5 4.31	45 1.78	2 - 3/8 x 55 2 - M10X57
RD1G048	RD1G048G	40 1½	48.3 1.900	500 3.45	6.3/1420	0-3.2 0-0.13	72 2.84	115 4.53	45 1.78	2 - 3/8 x 55 2 - M10X57
RD1G060	RD1G060G	50 2	60.3 2.375	300 2.07	5.9/1330	0-3.2 0-0.13	85 3.35	131 5.16	45 1.78	2 - 3/8 x 55 2 - M10X57
RD1G076	RD1G076G	65 2½	76.1 3.000	300 2.07	9.4/2120	0-3.2 0-0.13	101 3.98	147 5.78	45 1.77	2 - 3/8 x 55 2 - M10X57
RD1G089	RD1G089G	80 3	88.9 3.500	300 2.07	12.8/2885	0-3.2 0-0.13	115 4.53	170 6.69	46 1.82	2 - 1/2 x 70 2 - M12X70
RD1GS089	RD1GS089G	80 3	88.9 3.500	300 2.07	12.8/2885	0-3.2 0-0.13	114 4.50	160 6.30	45 1.78	2 - 3/8 x 55 2 - M10X57
RD1G114	RD1G114G	100 4	114.3 4.500	300 2.07	21.2/4770	0-3.2 0-0.13	146 5.75	200 7.88	52 2.05	2 - 1/2 x 70 2 - M12X70
RD1GS114	RD1GS114G	100 4	114.3 4.500	300 2.07	21.2/4770	0-3.2 0-0.13	140 5.51	192 7.56	50 1.97	2 - 1/2 x 70 2 - M12X70
RD1G139	RD1G139G	125 5	139.7 5.500	450 3.10	47.5/10680	0-3.2 0-0.13	170 6.69	238 9.37	52 2.05	2 - 5/8 x 85 2 - M16X85
RD1G168	RD1G168G	150 6	168.3 6.625	300 2.07	46.0/10340	0-3.2 0-0.13	202.0 7.95	270 10.63	52 2.05	2 - 5/8 x 85 2 - M16X85
RD1G219	RD1G219G	200 8	219.1 8.625	450 3.10	116.9/26280	0-3.2 0-0.13	260.0 10.24	346 13.625	62 2.44	2 - 3/4 x 115 2 - M20X115
RD1G273	RD1G273G	250 10	273.0 10.750	300 2.07	121.0/27210	0-3.2 0-0.13	327 12.88	420 16.54	63 2.48	2 - 7/8 x 125 2 - M22X140
RD1G323*	RD1G323G*	300 12	323.9 12.750	300 2.07	170.3/38280	0-3.2 0-0.13	378 14.88	466 18.35	63 2.48	2 - 7/8 x 125 2 - M22X140

\* Not VdS Approved

DS: 8.51  
Issue B  
21/07/17  
© 2017 Rapidrop

Rapidrop Global Ltd  
T: +44 (0) 1733 847 510 F: +44 (0) 1733 553 958  
e: rapidrop@rapidrop.com  
w: www.rapidrop.com

# Standard Rigid Coupling Model 1G & 1GS



1. Pipe Preparation

Check pipe end for proper groove dimensions and to assure that pipe end is free of indentations and projections that would prevent proper sealing.



2. Lubricate Gasket

Check gasket to be sure it's compatible for the intended service. Apply thin lubricant to the outside and sealing lips of the gasket.



3. Gasket Installation

Slip the gasket over one pipe, making sure the gasket lip does not over-hang the pipe end.



4. Alignment

After aligning two pipe ends together, pull the gasket into position, centering between the grooves on each pipe. The gasket should not extend into the groove on either pipe.



5. Housing Installation

Remove one bolt&nut and loosen the other nut. Place one housing over the gasket, making sure the housing keys fit into the pipe grooves. Swing the other housing over the gasket and into the grooves on both pipes. Re-insert the bolt and connect two housings.



6. Tighten Nuts

Check gasket to be sure it's compatible for the intended service. Apply thin lubricant to the outside and sealing lips of the gasket.



7 a. Assembly completed - Rigid Coupling

Slip the gasket over one pipe, making sure the gasket lip does not over-hang the pipe end.



7 b. Assembly Completed Flexible Coupling

After aligning two pipe ends together, pull the gasket into position, centering between the grooves on each pipe. The gasket should not extend into the groove on either pipe.

### Caution

Proper torquing of bolts is required to obtain specified performance.

- Over torquing the bolts may result in damage to the bolt and / or casting which could result in pipe joint separation.
- Under torquing the bolts may result in lower pressure retention capabilities, lower bend load capabilities, joint leakage and pipe joint separation. Pipe joint separation may result in significant property damage and serious injury.

### Specified Bolt Torque ANSI BOLTS

Bolt Size Inch	Specified Bolt Torque	
	Lbs-Ft.	N.m
3/8	30-45	40-60
1/2	80-100	110-135
5/8	100-130	135-175
3/4	130-180	175-245
7/8	180-240	245-325