

Mini isolated valve

Art. 420

Mini isolated valve

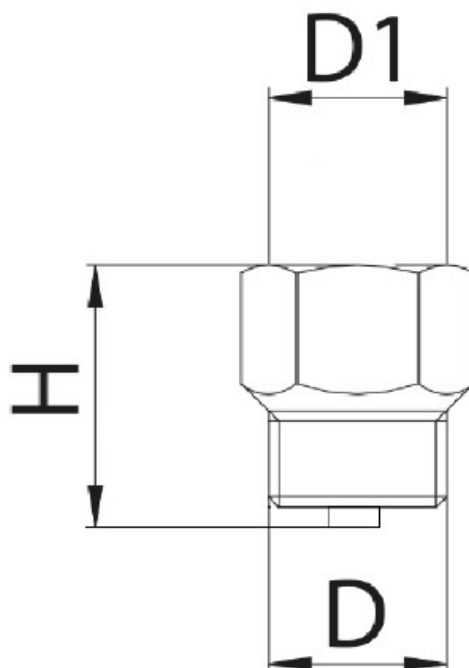

Items

Code	Size (D)	Smooth	Pack	D1	h
4200030300	3/8"	●	50	3/8"	23.0
Code	Size (D)	Smooth	Pack	D1	h
4200040300	1/2"	●	50	3/8"	24.0

4200040400	1/2"		50	1/2"	25.0
------------	------	---	----	------	------

SMOOTH

-  Yellow
-  Chrome
-  Nickel
-  White

Working temperature: 0-110°C (solar 140°C)

Max working pressure: 10 bar

Opening overpressure: 10%

Closing differential: 20%

Tolerance: 10%

Body in forged brass

Threads: ISO 228

Made in accordance with the safety requirements laid down in European Directive 2014/68/EU (PED)