

GENESIS VASOMULTI® NO RIM

GN002BI

CE EN 997:2015

GLOBO



Ceramic antibacterial effect
BATAFORM®



Glazed product with
CERASLIDE®



SENZABRIDA®



Drain 4/2,6 lt



Bagno di Colore

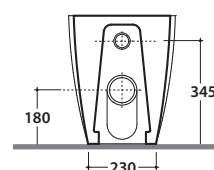
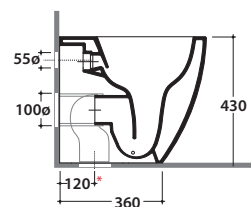
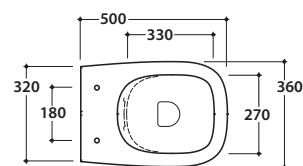

Cod. **GN002BI**

Floor mounted Wc No-rim 50.36 h43 cm. with adjustable water inlet/outlet MULTI. Drain 4 / 2,6 Lt. Back to wall installation. FISSAGGIOGHOST® Fixing kit included. Weight 24 Kg



Seat-cover with hinge system
to quick release



Antibacterial treatment on toilet seats
in shiny white

Cod. **GN022BI**

Duroplast seat-cover with soft-closing system. Weight 3 Kg

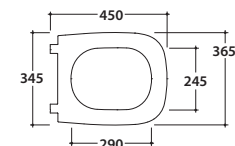
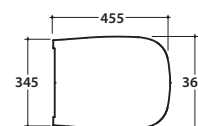

Cod. **VA092 ***

Elbow pipe for floor drain. Adjustable 6/9 cm. Output can be combined with fittings up to ø.110. Weight 0,3 Kg

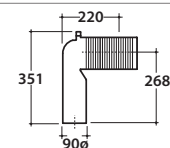

Cod. **VA093 ***

Elbow pipe for floor drain. Adjustable 10/12 cm. Output can be combined with fittings up to ø.110. Weight 0,3 Kg

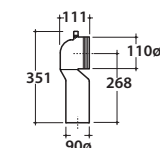

Cod. **VA094 ***

Elbow pipe for floor drain. Adjustable 13 / 18 cm. Output can be combined with fittings up to ø.110. Weight 0,3 Kg

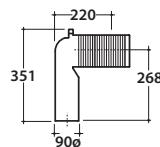

Cod. **VA086 ****

Eccentric pipe for water inlet 33/36cm. Weight 0,1 Kg

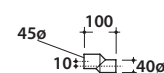

Cod. **VA076**

Pipe for wall drain 35cm

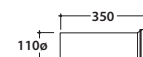

Cod. **VA132**

Flow reducer.