



Producator: ***Brandoni Italia***

## **Supapa de sens cu ventil, arc si flanse pentru apa, din fonta**

***Model: F5***



### ***FISA TEHNICA***

Revizia nr. 0 / octombrie 2010

Seria 05

Supape de sens cu arc si flanse

F5 Cu flansa

T5 Filetat

50 Filtru

- Pentru instalatii de apa, incalzire, climatizare, aer comprimat.
- Obturator cu arc.
- Se poate folosi in orice pozitie.
- Pierderi mici de sarcina.
- Vopsea epoxidica la interior si exterior.
- Conform Directivei 97/23 CE (PED)

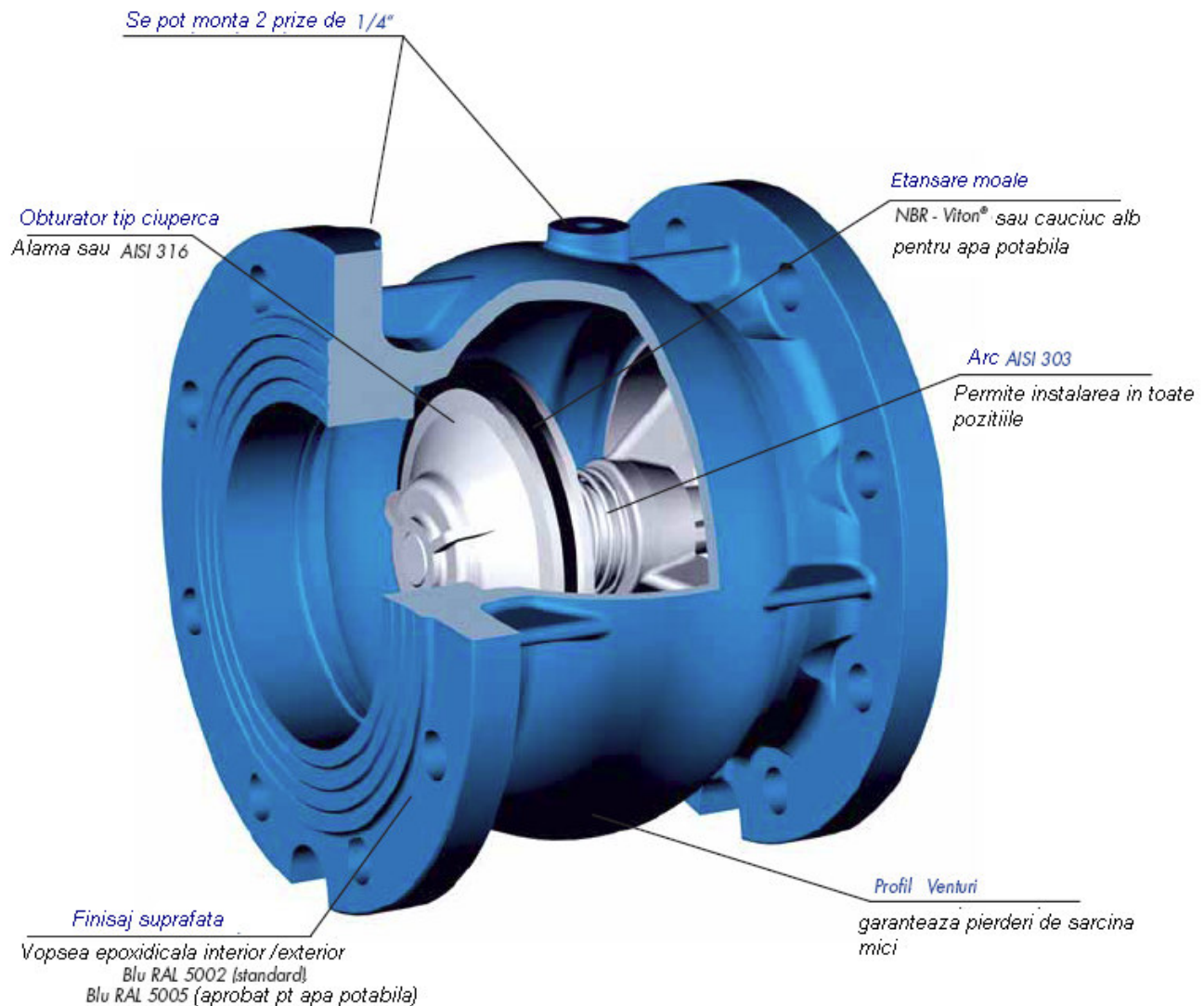

## SERIA 05

Supape de sens cu arc si filtre

Presiune: de la 0 la 16 bar



Art F5



Art T5

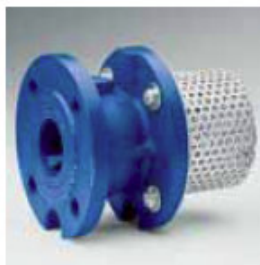

Sorb

### Articole disponibile

Art. F5.0 corp : Fonta G25

#### F5.000

- Obturator : G25
- Etansare: NBR
- Temp. de la 10 la 100°C

#### F5.002

- Obturator : G25
- Etansare: Viton
- Temp. de la -10 la 150°C

#### F5.22

- Obturator : AISI 316
- Etansare: Viton
- Temp. de la -10 la 150°C

#### F5.028

- Obturator : AISI 316
- Etansare: cauciuc pentru apa
- Temp. de la -10 la 70°C
- Certificare ACS Nr. 05 acc LY 123 pentru apa potabila la versiunea cu vopsea epoxidica si garniture din EPDM F5.028.....V1

Art. T.0 corpo : fonta G25

T5.000

- Obturator : G25
- Etansare: NBR
- Temp. de la -10 la 100°C

T5.002

- Obturator : G25
- Etansare: Viton
- Temp. de la -10 la 150°C

Filtru cu cos



Date tehnice

Dimensiuni	(in mm)							
DN	50	65	80	100	125	150	200	250
Ø	50	65	80	100	125	150	200	250
Ø <sub>1</sub>	50	64	64	80	-	-	-	-
Ø gauri	6	6	6	6	6	6	6	6
A	100	120	140	170	200	230	300	370
A <sub>1</sub>	140	167	177	208	-	-	-	-
C	165	185	200	220	250	285	340	405
D	111	131	148	168	198	222	278	329
D <sub>1</sub>	62	81	93	117	-	-	-	-
E	156	176	202	212	242	276	332	385
L	80	100	120	150	175	200	250	300
L <sub>1</sub>	85	85	105	118	-	-	-	-
Art. F5 (Kg)	5,6	7,6	9,8	13,8	20,6	28,6	48,6	81,4
Art. T5 (Kg)	2,2	3,2	4,2	7,4	-	-	-	-
Art. 50/52/53 (Kg)	0,55	0,74	0,93	1,2	1,6	2,2	3,2	4,4
Kv Art. F5	90	138	228	354	486	603	1060	1770
Kv Art. T5	90	138	138	228	-	-	-	-

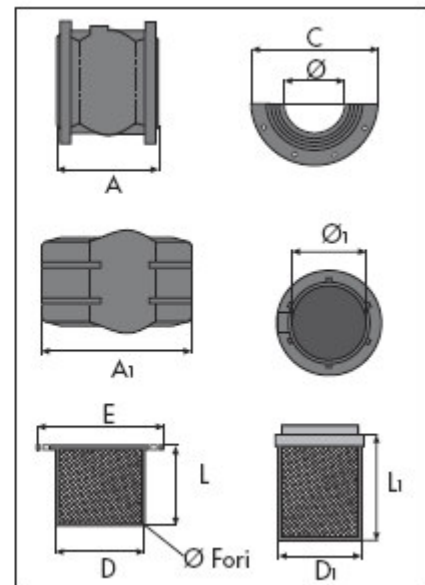

Pentru instalatii de apa, incalzire, climatizare, aerc omprimat.

Obturator cu arc.

Se poate folosi in orice pozitie.

Pierderi de sarcina mici.

Vopsea epoxidica la interior si exterior.

Conform directivei 97/23/CE (PED)

Presiune : de la 0 la 16 bar

Presiune minima de functionare : 1 bar

Temperatura: -10 + 90°C NBR, -10 + 140°C Viton, -10 + 70°C cauciuc pentru apa certificare ACM

Art. F5

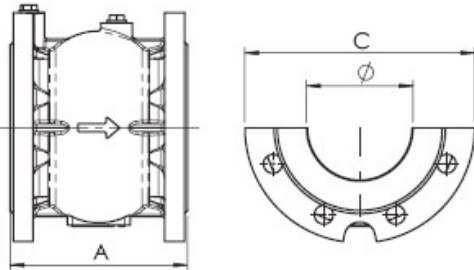

Art. T5

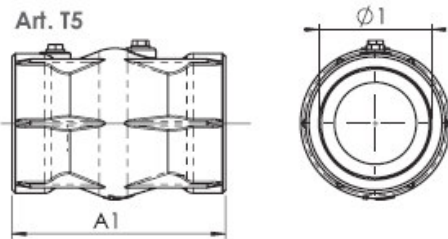

Dimensiuni / Dimension (mm)	50	65	80	100	125	150	200	250
DN	50	65	80	100	125	150	200	250
Ø	50	65	80	100	125	150	200	250
Ø1	50	64	64	80	-	-	-	-
A	100	120	140	170	200	230	300	370
A'	140	167	177	208	-	-	-	-
C	165	185	200	220	250	285	340	405
Masa / Weight (Kg)								
Art. F5	5,6	7,6	9,8	13,8	20,6	28,6	48,6	81,4
Art. T5	2,2	3,2	4,2	7,4	-	-	-	-

F5 Ecartament: nenormalizat / Face - to - face: not standardised

Gama : PN 16 DIN 2501

T5 Ecartament: nenormalizat / Face - to - face: not standardised

Filete / Threads: F/F UNI ISO 228/1 - GAS - BSP

Diagrama pierderi de sarcina cu fluid apa  
Seria 05

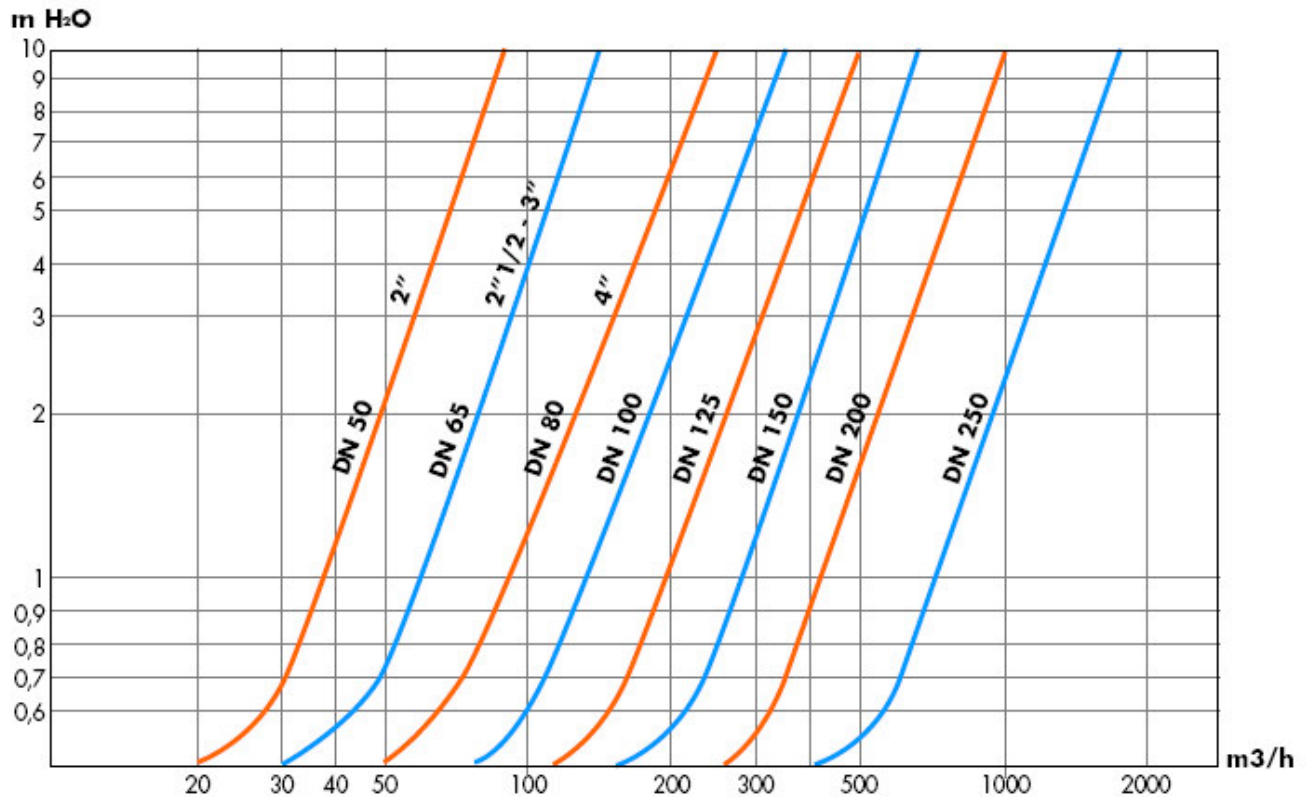





**Tabel Kv - DN Kv - DN**

DN	50	65	80	100	125	150	200	250
KV m <sup>3</sup> /h	99	145	258	360	516	620	985	1620

**Presiune minima de deschidere mmH<sub>2</sub>O - Minimum operating pressure mmH<sub>2</sub>O**

Directie flux

Flow direction	DN	50	65	80	100	125	150	200	250
		639	647	592	624	570	526	639	690
		382	316	280	318	180	165	221	204
		510	480	436	470	375	345	429	448
	fara arc without spring	125	165	155	152	203	185	208	244

**N.B. 1 m H<sub>2</sub>O = 0,098 bar**

Datele si caracteristicile din aceasta fisa tehnica sunt doar orientative

DT042

Data and features indicated in this brochure are just for information.

CA.05/12-2005/I-GB

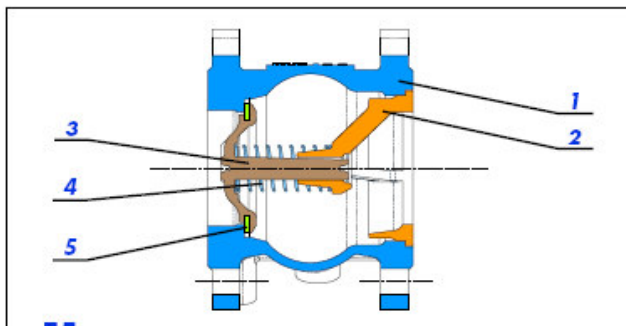

**F5 DN 50-100**

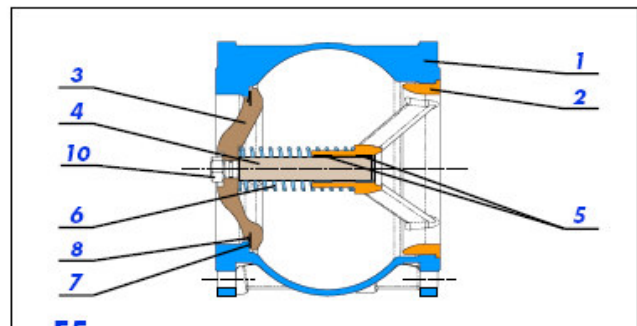

**F5 DN 200-250**

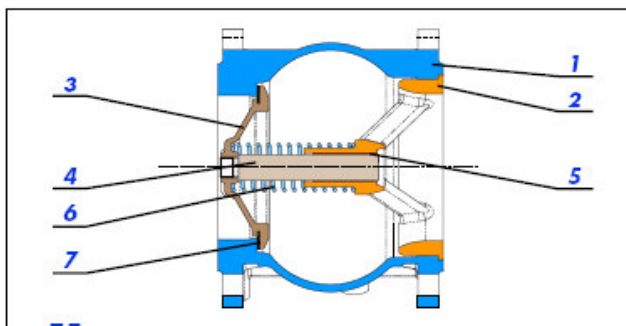

**F5 DN 125-150**

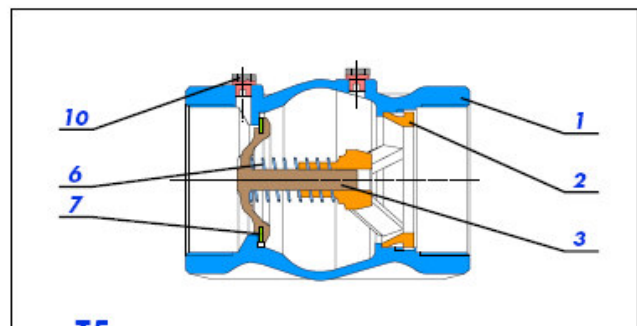

**T5**

		F5.000 T5.000	F5.002 T5.002	F5.008 T5.008	F5.020	F5.022	F5.028
<b>N° Den.</b>	<b>Cantitate</b>						
1 Corp	1	Fonta G25					
2 Ghidaj (DN 50-100)	1	Alama Fonta /CuZn40Pb2			AISI 316		
2 Ghidaj (DN 125-250)	1	Fonta G25			AISI 316		
3 Obturator (DN 50-100)	1	Alama Fonta /CuZn40Pb2			AISI 316		
3 Obturator (DN 125-250)	1	Fonta G25			AISI 316		
4 Tija (DN 125-250)	1	Alama Fonta /CuZn40Pb2			AISI 316		
5 Manson (DN 125-250)	1-2	Alama Fonta /CuZn40Pb2			-		
6 Arc	1	AISI 302					
7 Etansare	1	NBR	Viton*	EPDM**	NBR	Viton*	EPDM**
8 Piulita (DN 200-250)	1-2	Alama CuZn40Pb2			AISI 316		
9 O Ring (DN 200-250)	1	NBR	Viton*	NBR	NBR	Viton*	NBR**
10 Dop de golire cu O Ring*	1-2	Otone/NBR					

\* Optional  
\*\* Adecvata pentru apa potabila

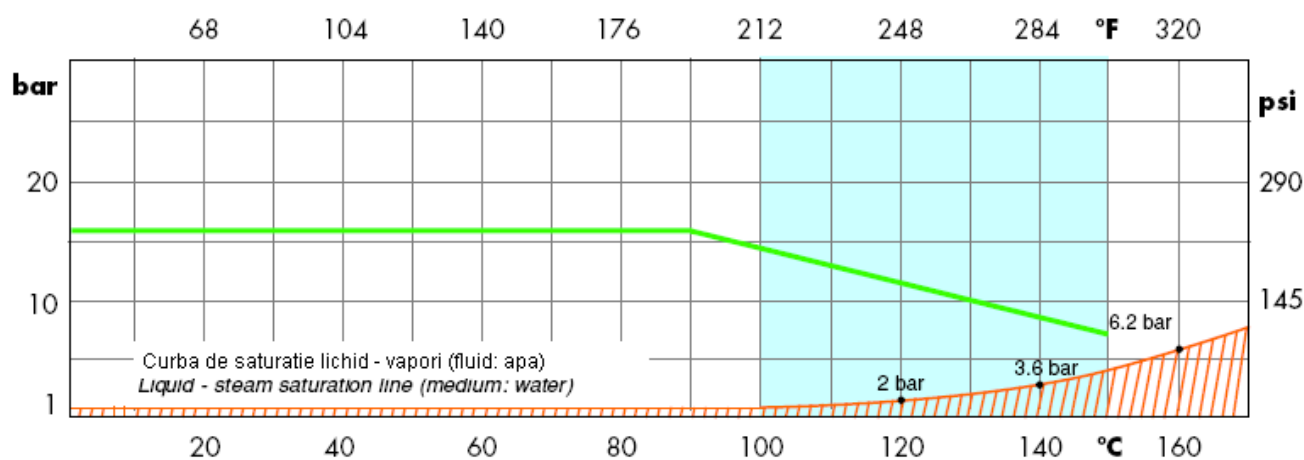

Cu O – ring din Viton

Nu este adecvata pentru vapori: NU utilizati in conditii de temperatura si presiune sub curba de saturatie a lichidului – vapori (zona hasurata )

Colectivul de redactare a cartii tehnice:

Traducere, tehnoeditare: **Daiana ONISIE**

BUCURESTI - ROMANIA - Sos. Vitan-Barzesti nr. 11A, sector 4; Tel/Fax: 021-332.09.01, 334.94.63;  
Reg. Com. J/40/14205/1994 - Cod fiscal R 5990324 - Cont RO74RNCB501000000130001 B.C.R.  
Sector 1, BUCURESTI - RO43BACX0000000030565310 HVB sucursala Grigore Mora  
BUCURESTI; Capital Social: 139.400.000.000 ROL (13.940.000 RON)

