

## NANOPB

### NANO Wiegand Proximity Reader

The NANO from CDVI is a mini and compact proximity card reader.

These stylish new readers are available in both black and white. As with the other readers from the range (STAR, SOLAR and MOONAR), the NANO gives an anytime status of the door through multi-coloured LED's.

These access control readers have a high performance read range and are easy to mount.

We, CDVI, declare that the NANO radio equipment complies with directive 2014/53/UE. The full text of the EU declaration is available at [www.cdvi.com](http://www.cdvi.com)

- Wiegand 26, 30 or 44-bit
- Audible and visual feedback
- Reads CDVI 125 kHz cards and tags
- Up to 4 in. (10 cm) read range
- Power requirements: 12V DC
- Current consumption: 150 mA
- Multicoloured LED:
  - Blue: Standby
  - Green: Access Granted
  - Red : Access Denied

 RED Certification

 CE Certification

 Vibrations

 -25°C to +70°C

 IP53

 IK10

 WEEE

 UK  
CA

 RoHS



**NANOPB**

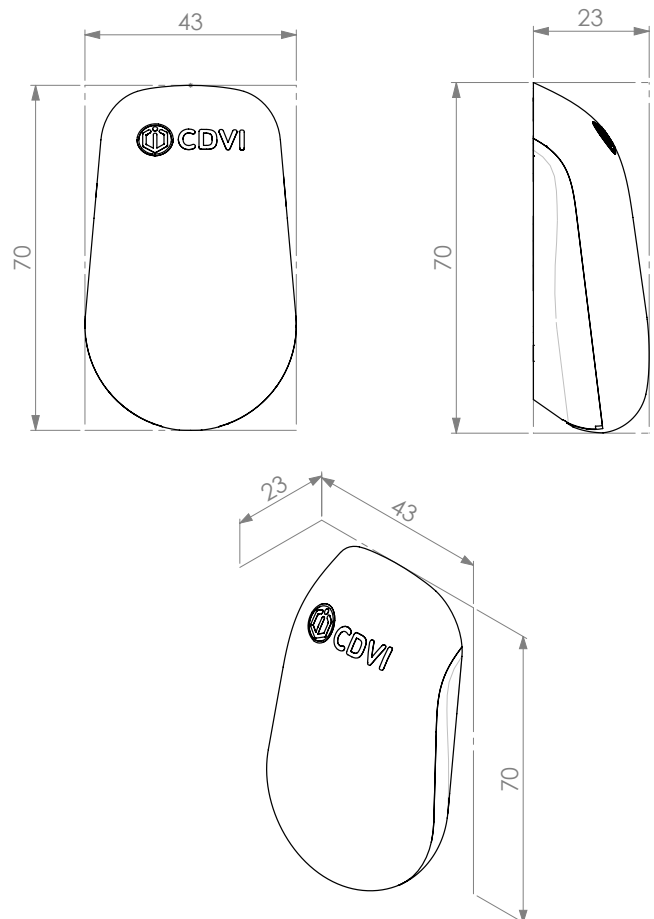

## MOUNTING

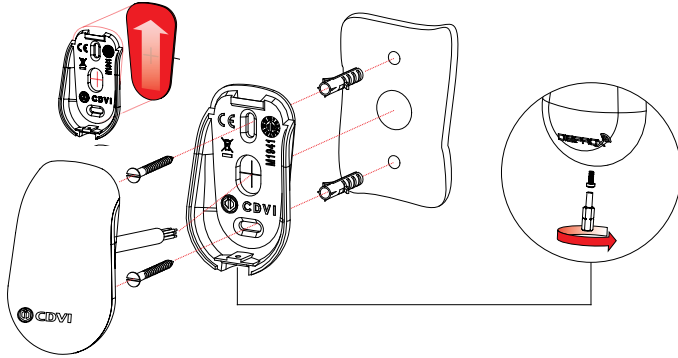

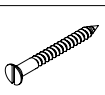
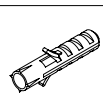
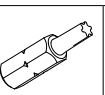
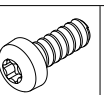
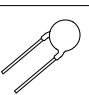
					
1	2	2	1	1	1

## WIRING DIAGRAM

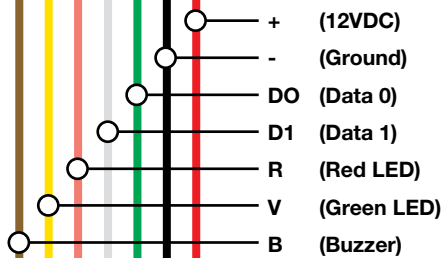
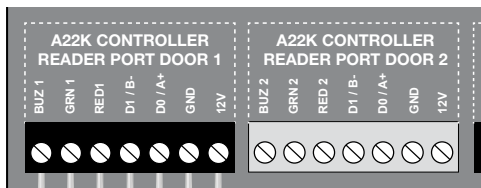

Cable	
Red	Input voltage 12V dc
Black	0V
Blue	Clock
Green	Data 0
White	Data 1
Brown	Buzzer
Yellow	Green LED
Orange	Red LED

## LED & AUDIBLE TONE

### When powered

- Green LED illuminates for 1 second
- Red LED illuminates for 1 second
- Buzzer sounds for 1 second

### Operating mode

- Buzzer activated with 0V input
- LEDs activated with 0V input

Green LED	Red LED	Status
OFF	OFF	OFF
OFF	ON	red
ON	OFF	green
ON	ON	blue

### Card Swiped

- *Badge recognized*: the orange LED illuminates and the buzzer activates for 150 milliseconds.
- *Badge not recognized*: no change.

### Wiegand output formats

DIP1	DIP2	BITS
OFF	OFF	26
ON	OFF	30
OFF	ON	44

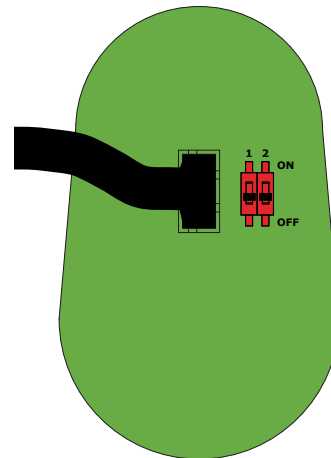

**CDVI SAS**  
31 Général Leclerc Ave  
93500 PANTIN  
01 48 91 01 02



# NANOPB

## Lecteurs de proximité Wiegand

Le NANO de CDVI est un lecteur de cartes de proximité compact.

Ces lecteurs élégants sont disponibles en noir et en blanc. Comme avec les autres lecteurs de la gamme (STAR, SOLAR et MOONAR), le NANO affiche le statut de la porte à tout moment grâce à des LED multicolores.

Ces lecteurs de contrôle d'accès ont une plage de lecture haute performance et sont faciles à installer.

Nous, CDVI, déclarons que l'équipement radioélectrique NANO est conforme aux exigences de la directive européenne 2014/53/UE. La déclaration UE de conformité est accessible sur [www.cdvi.com](http://www.cdvi.com).

- Wiegand 26, 30 ou 44 bits
- Signalisation lumineuse et sonore
- Cartes et badges CDVI 125 kHz
- Jusqu'à 10 cm de portée
- Alimentation : 12V DC
- Consommation : 150 mA
- Voyant LED (3 couleurs) :
  - Bleu : veille
  - Vert : accès autorisé
  - Rouge : accès refusé

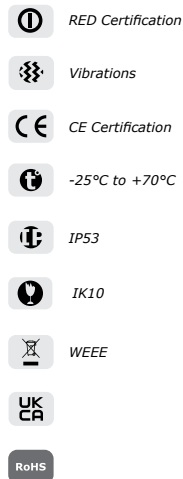

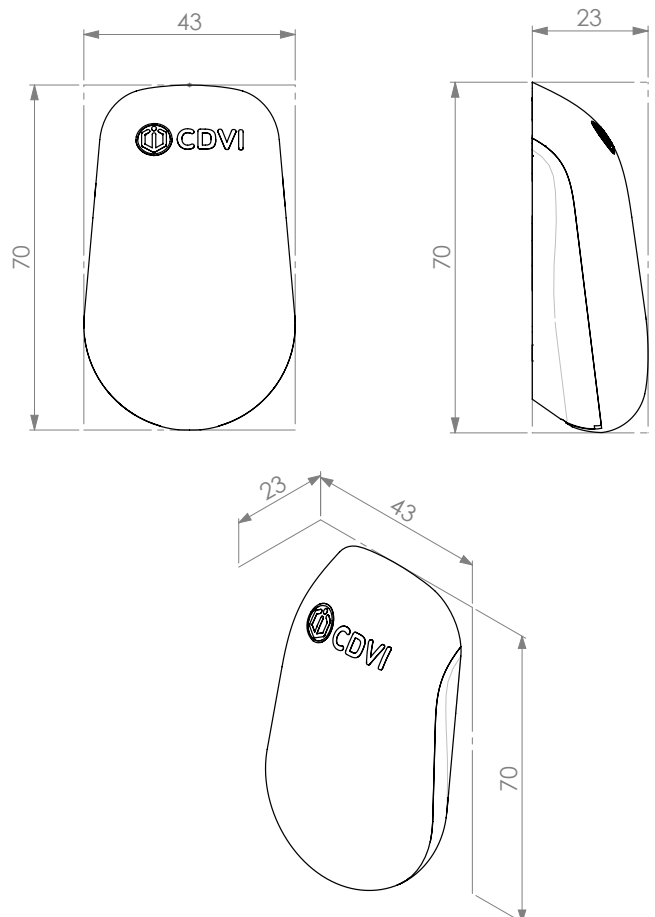

**NANOPB**

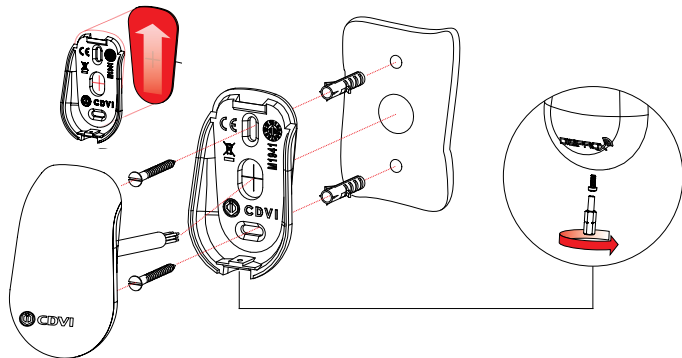

Bande de fréquence RFID: 125 kHz  
Puissance maximale transmise en dessous de la limite maximale autorisée <60dBµA/m

## MONTAGE

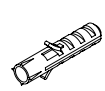
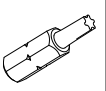
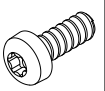
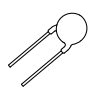

					
1	2	2	1	1	1

## RACCORDEMENTS

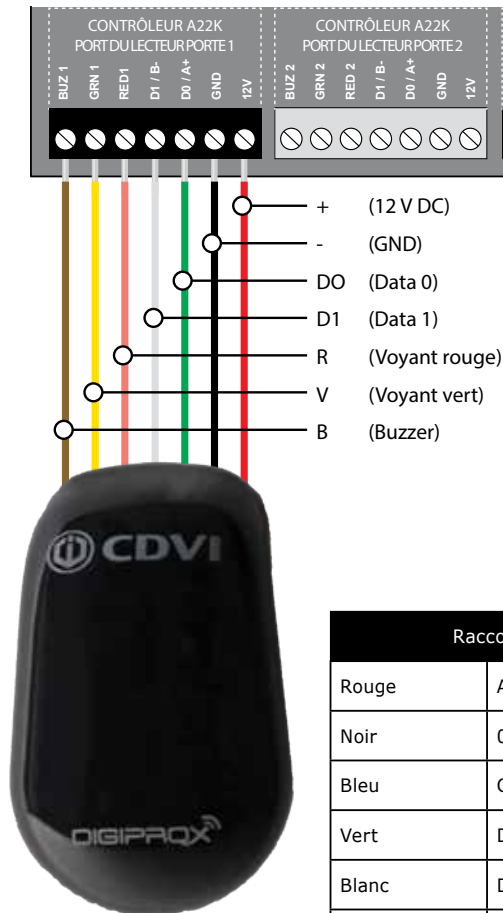

Raccordement	
Rouge	Alimentation 12 V DC
Noir	0 V
Bleu	Clock
Vert	Data 0
Blanc	Data 1
Marron	Buzzer
Jaune	Voyant vert
Orange	Voyant rouge

## FONCTIONNEMENT

### Mise sous tension

- Voyant vert pendant 1 seconde
- Voyant rouge pendant 1 seconde
- Voyant bleu pendant 1 seconde avec bip

### Fonctionnement

- Activation Buzzer par niveau 0 V
- Activation voyants par niveau 0 V

Voyant vert	Voyant rouge	Etat
OFF	OFF	éteint
OFF	ON	rouge
ON	OFF	vert
ON	ON	bleu

### Présentation badge

- *Badge lu* : voyant orange et bip pendant 0,15 seconde puis retour suivant état activation en cours.
- *Badge non lu* : pas d'effet.

### Formats de sortie Wiegand

DIP1	DIP2	BITS
OFF	OFF	26
ON	OFF	30
OFF	ON	44

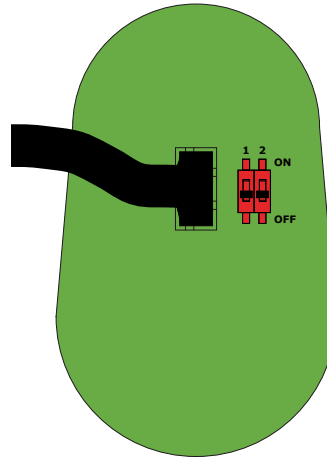

**CDVI SAS**  
31 avenue du Général Leclerc  
93500 PANTIN  
01 48 91 01 02

