

KS12300005.300

### Description and functionalities

**auxi-H** is a module that can be used not only in security but also for home automation; it connects to lares 4.0 through the KS-BUS 4-wire serial bus.

Thanks to a dedicated jumper on the board, it is possible to set two operating modes:

- **auxi-HT**: in this mode the device is designed for the full management of windows equipped with motorized roller shutters (with two interlocked relay outputs). The roll-up shutters can be opened or closed completely from the scenarios configured on lares 4.0. With the local buttons it is possible to manage the classic movement with man present, but also to manage the complete opening and closing.
- **auxi-HL**: in this mode the device is designed to manage lights, the two relay outputs can be both freely controlled by the scenarios of lares 4.0 and managed locally by connecting the buttons to the local inputs. In fact, in both operating modes, there are 2 freely configurable inputs and an alarm input connectable to the shutter sensors.

In both modes, the device also provides two freely configurable alarm inputs and a reserved input for the management of shutter-type detectors

With a single device it is possible to completely control any spot equipped with motorized roller shutters. It is able to control the motors, move the roller shutters, even when the system is armed and without the need to disarm it and more, one of the inputs can be configured to block the movement of the roller shutter (for example with the installation of a photocell); it does not give the opportunity to just open and close roller-shutters, it is also capable to set them in intermediate positions; the local buttons continue to work even in the event of a control panel failure.

### ACCESSORIES

- KS17300000.001 - Plastic box for DIN rail  
Dimensions:  
84x54x26mm (hxxwxd)



- KS17302000.010 - Plastic box "slim" version for housing up to 2 modules  
Dimensions:  
140x101x28,9mm (hxxlxxp)



### Roller Blinds Management

### Lights Management

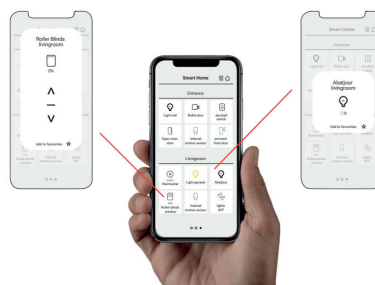

Its small dimensions allows its installation inside a standard DIN 503 box for wall mounting or alternatively into the plastic "slim" box (code KS17302000.010) that can house up to two moduls.

### Quantity data

lares 4.0 models	wls 96	16	40	40 wls	140 wls	644 wls
Maximum number of expansion modules (auxi, auxi-relé, auxi 10in, auxi-L, auxi-H, auxi-A, auxi-1)	6*	4**	24	24	64	200

\* Supports only auxi, auxi-1, auxi-A and auxi-H  
\*\* Does not support auxi-H

### Technical data

Power supply	13.8 Vdc
Consumption	70 mA (Terminal P excluded)
Relais output	2 at 250 V - 8A
Alarm input	2 (programmable EOL)
Roller shutter dedicated input	1
Input for local button	2
Power terminal	1 at 0,5A (protected by a self-restorable thermal fuse)
Fast addressing system on KS-BUS	
Operating temperature	from +5°C to +40°C
Humidity	95%
Dimensions	45x75x16 mm (HxWxD)
Weight	100 gr.

### COMPLIANCE

Europe - CE

