

ZKBio CVAccess

Professional Attendance & Access Control
A Lightweight Solution for SMB Market

Introduction

ZKBio CVAccess is a lightweight web-based security platform that utilizes hybrid biometric technology and computer vision technology.

It is designed to support most ZKTeco Hardware and offers a wide range of features to meet the management needs of small to medium-sized businesses: Personnel Management, Access Control, Time & Attendance, Smart Video Surveillance, System Management.



Features

Access Control

- Person Access Level Control.
- Standard Anti-passback, Interlock, Linkage functions.
- Supports ZKTeco's access control terminals: SpeedFace Series / InBio Series / C3 Series / SF Series / LF Series etc.
- Video analytics alarm notifications.
- Door status real-time monitoring.
- Intuitive control on E-map.
- Supports expansion board for more applications.

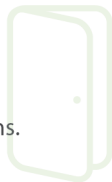

Time & Attendance

- Flexible shift scheduling.
- Set attendance by area or by different person.
- Web-based attendance module suitable for multiple locations.
- Multiple reports for attendance statistics and support for customized reports.
- Automatic attendance report email to administrator.



Smart Video Surveillance

- Up to 64 channels preview and 16 channels real-time playback simultaneously.
- Basic video management features such as real-time preview, PTZ control, video playback, and TV Wall, E-map.
- Video analytics alarm notifications such as behavioural analysis, situation analysis based on human & vehicle targets intelligent via multiple video analytic features such as target counting, line crossing, area intrusion detection, etc.
- Alarm linkage actions (capture/record/PTZ/pop-up prompts).
- Video patrol helps security guards to increase situational awareness and patrol performance. The software can keep the entire patrol records.
- The watermark function protects and prevents users photos and data from being copied and reused without permission.
- Supports video intercom: After the device initiates the ringing, the host interface in the LAN will automatically pop up the intercom window to complete the operations such as answering, hanging up, and opening the door.



Video Intercom NEW

- Enhanced Security: Real-time video communication for user to identify visitors enter.
- Simplified Configuration: The software automatically assigns SIP accounts, quickly synchronizing them with devices and apps, eliminating the hassle of manual configuration.
- Access Control Integration: In emergency situations, the system automatically triggers notifications to designated emergency contact applications, ensuring critical alerts are immediately transmitted and no urgent communications are missed.
- Mobile users can use the Senseface 2/3/4 series with the ZKBio Zexus mobile app for video intercom. Meanwhile, Biotalk Pro is available for desktop clients.



Product Comparison

Note: If you require additional features and better performance, we recommend upgrading to ZKBio CVSecurity.

Performance	ZKBio CVAccess	ZKBio CVSecurity
Access Control Doors	25	5,000
Attendance Points	25	2,000
Video Channels	256	1,024
Intercom Terminal Account (SIP Account)	100	40,000
Supported Personnel	3,000	300,000
Number of Clients Allowed to Access	Unlimited	Unlimited
Operation System & Database	Windows7 / 8 / 10 / 11, Windows Server 2008 / 2012 / 2016 / 2019 / 2022, PostgreSQL, Oracle11g / 12c / 18c / 19c / 21c, SQL Server 2008 / 2012 / 2014 / 2016 / 2017 / 2019 / 2022	

Function	ZKBio CVAccess	ZKBio CVSecurity
General		
Personnel	√	√
System		
Operation Log	√	√
Database Management	√	√
System Monitoring	√	√
Message Notification	Email	Email / WhatsApp / SMS
Account and Security	√	√
API Authorization	×	√
Mobile APP	√	√
OCR Scanner	√	√
Card Template	√	√
Active Directory	×	√
Map		
E-map	√	√
GIS Map	×	√
Event & Alarm Center	×	√

Function		ZKBio CVAccess	ZKBio CVSecurity	
Application				
Access Control	Access Level	√	√	
	Interlock	√	√	
	Linkage	√	√	
	Anti-Passback	√	√	
	First-Person Normally Open	√	√	
	Multi-person Opening	√	√	
	Advanced Functions	Global Interlock	×	√
		Global Anti-Passback	×	√
Global Linkage		×	√	
Personnel Availability		×	√	
Occupancy Control		×	√	
	Emergency Muster	×	√	
Video Intercom	DNK Devices Management	×	√	
	SIP Intercom	√ (V4.2.0 and above supported)	√	
	Extension Number Assignment		√	
	Cloud SIP Server		√	
	PBX Server Mode		√	
			√	
Time & Attendance	Attendance Rule	√	√	
	Approval Workflow	×	√	
	Shift	√	√	
	User Defined Report	√	√	
Video Surveillance	View / Live View / PTZ Control / Playback	√	√	
	Favorites	√	√	
	ONVIF	√	√	
	TV Wall	√	√	
	Intelligent Video Setting	√	√	
	Linkage	√	√	
	Video Patrol	√	√	
	Maintenance	√	√	
Elevator Control & DCS Integration		×	√	
Entrance Control		×	√	
Visitor		×	√	
Parking Management		×	√	
Guard Patrol		×	√	
Consumption		×	√	
Intelligent Analytics		×	√	
Intrusion Alarm		×	√	
Locker Management		×	√	

System Topology

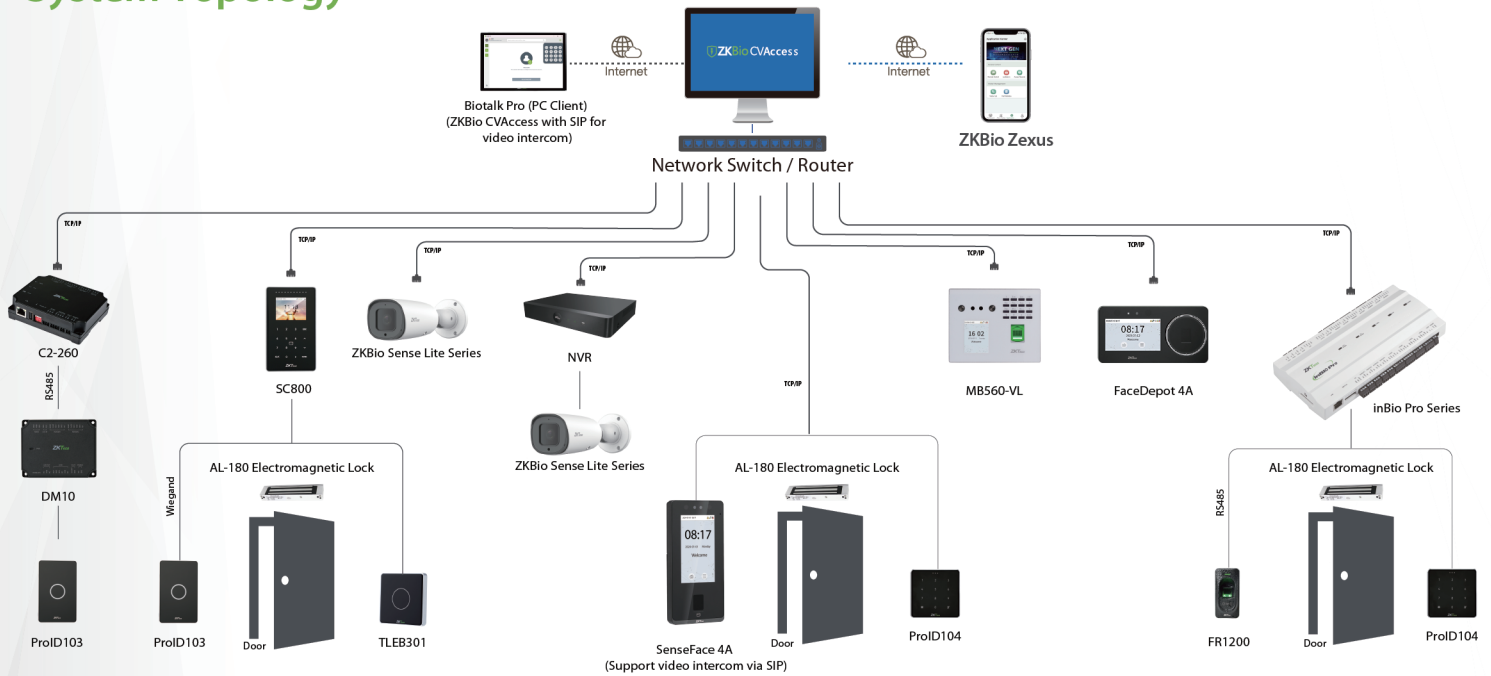

Mobile APP-ZKBio Zexus

Admin Page

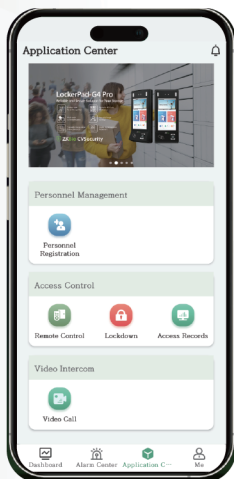

Keep an eye on everything, guard every moment, 24/7 security defense.

Personnel Page

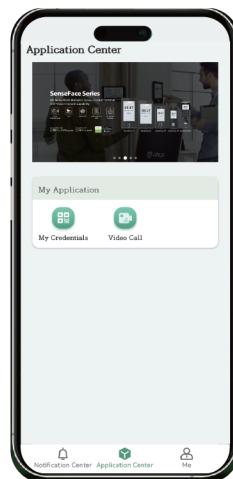

You can reserve the space and manage visitors on the mobile app.

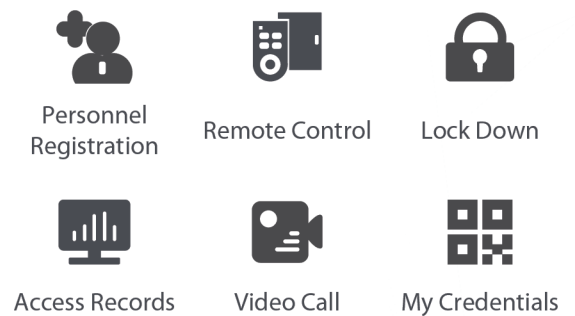

iOS



Android

